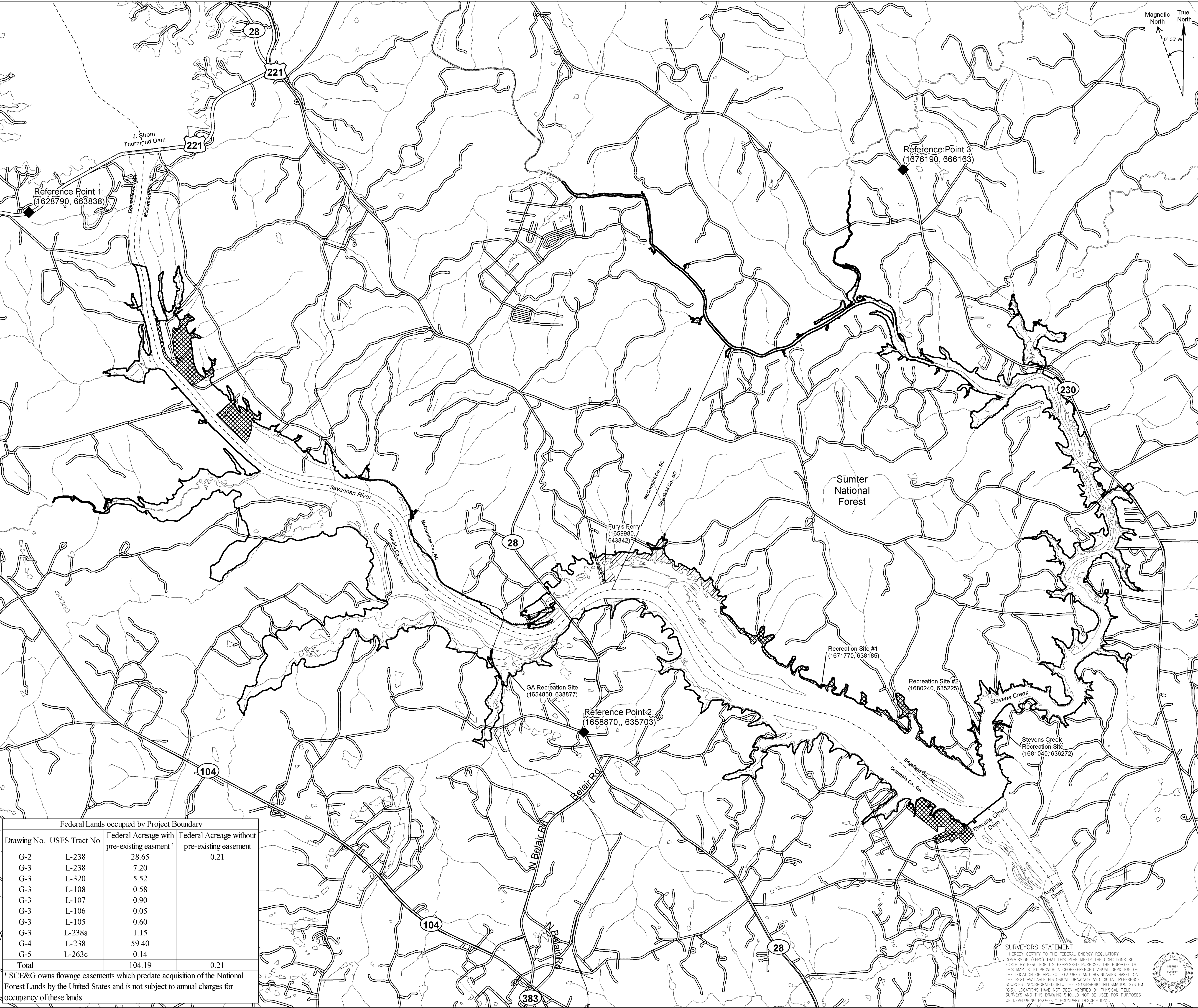

EXHIBIT G

PROJECT BOUNDARY MAPS



Path: G:_Client_Data\SCE&G\Stevens Creek_MXD\Stevens Creek PBL Index.mxd

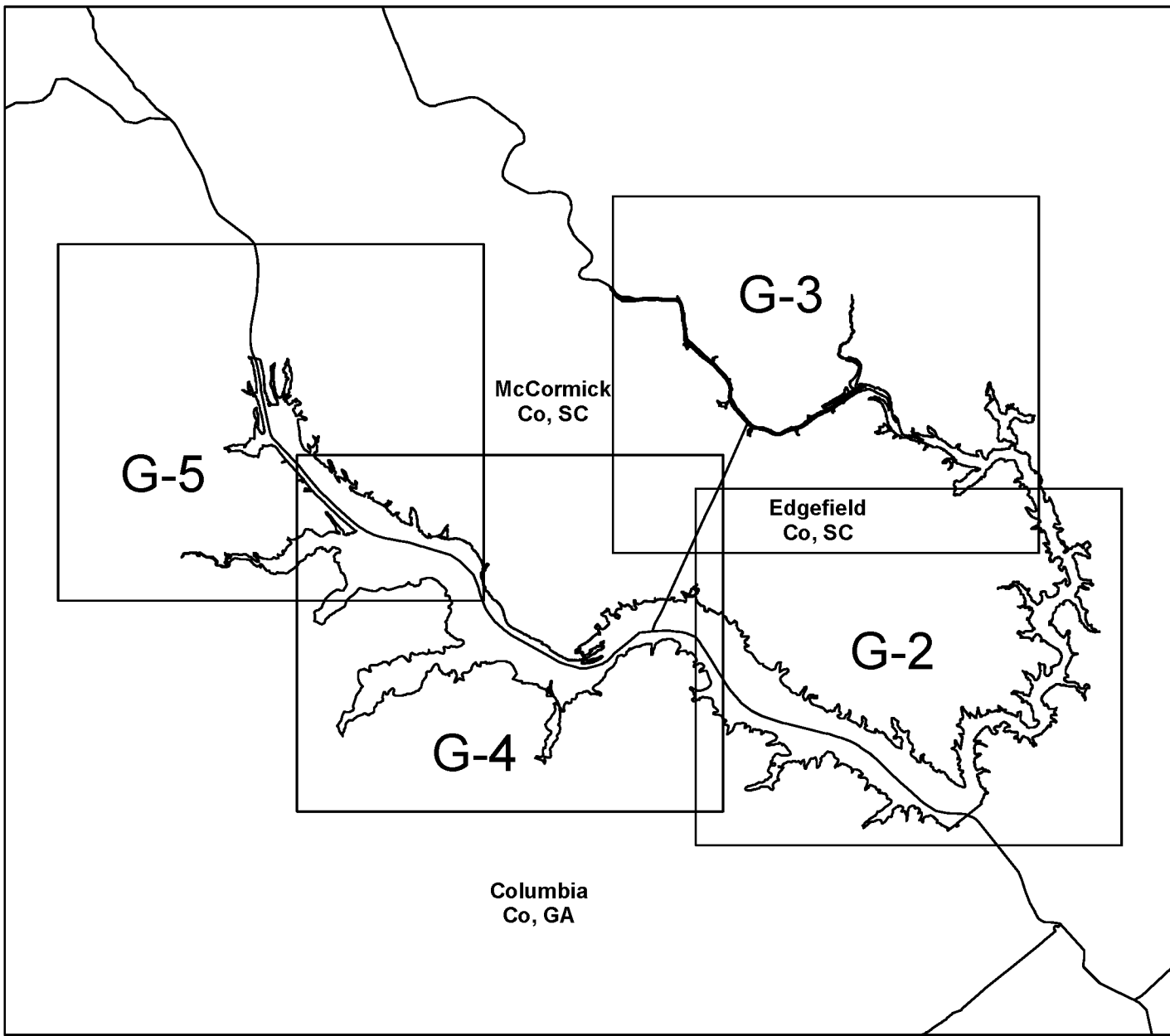

Federal Lands occupied by Project Boundary			
Drawing No.	USFS Tract No.	Federal Acreage with pre-existing easment ¹	Federal Acreage without pre-existing easement
G-2	L-238	28.65	0.21
G-3	L-238	7.20	
G-3	L-320	5.52	
G-3	L-108	0.58	
G-3	L-107	0.90	
G-3	L-106	0.05	
G-3	L-105	0.60	
G-3	L-238a	1.15	
G-4	L-238	59.40	
G-5	L-263c	0.14	
Total		104.19	0.21

¹ SCE&G owns flowage easements which predate acquisition of the National Forest Lands by the United States and is not subject to annual charges for occupancy of these lands.



- Project Boundary Line
-  Property owned in fee by SCE&G
-  USFS Land within PBL (without pre-existing easement)
-  USFS Land Within PBL (with pre-existing easement)

- Note:
1. SCE&G owns flowage easements which predate acquisition of the National Forest Lands by the United States and is not subject to annual charges for occupancy of these lands.
 2. SCE&G's property rights within the Stevens Creek Project Boundary consist only of flowage rights except for the project structures and the properties designated as being owned in fee by SCE&G.

Coordinate System: NAD 1983 NSRS2007 StatePlane South Carolina FIPS 3900 Ft Intl
All elevations are in NAV88.

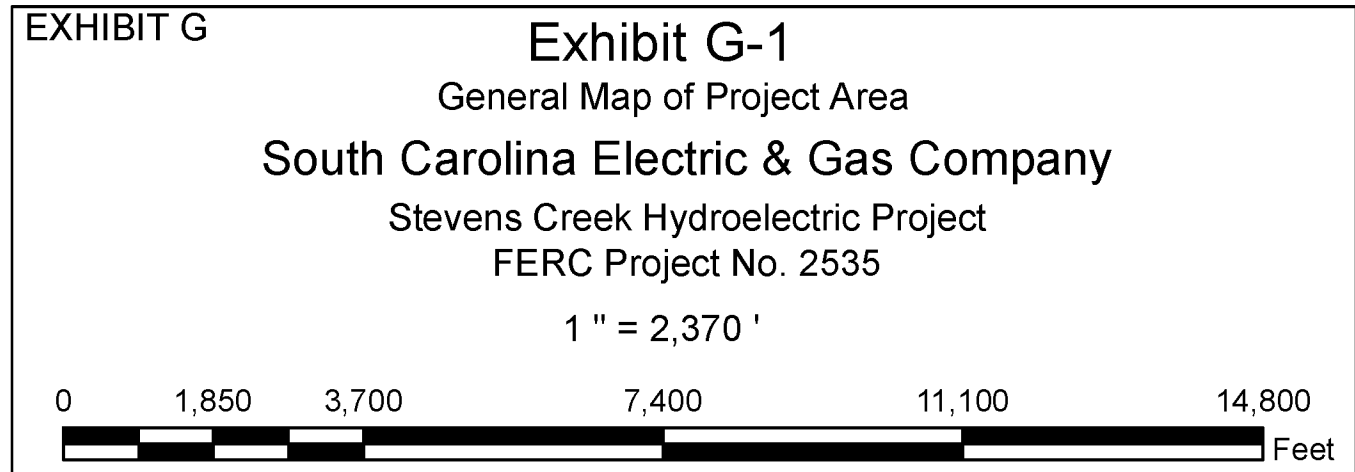

SURVEYORS STATEMENT
I HEREBY CERTIFY TO THE FEDERAL ENERGY REGULATORY COMMISSION (FERC) THAT THIS PLAN MEETS THE CONDITIONS SET FORTH BY FERC FOR ITS EXPRESSED PURPOSE. THE PURPOSE OF THIS MAP IS TO PROVIDE A GEOREFERENCED VISUAL DEPICTION OF THE LOCATION OF PROJECT FEATURES AND BOUNDARIES BASED ON THE BEST AVAILABLE HISTORICAL DRAWINGS AND DIGITAL REFERENCE SOURCES INCORPORATED INTO THE GEOGRAPHIC INFORMATION SYSTEM (GIS). LOCATIONS HAVE NOT BEEN VERIFIED BY PHYSICAL FIELD SURVEYS AND THIS DRAWING SHOULD NOT BE USED FOR PURPOSES OF DEVELOPING PROPERTY BOUNDARY DESCRIPTIONS.

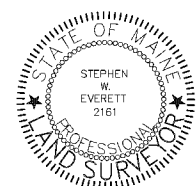

Point A			Point B			Point C		
Line	Bearing	Length	Line	Bearing	Length	Line	Bearing	Length
1	S89°49'40"E	56.06'	1	S69°1'8"W	127.60'	1	S69°55'24"E	66.51'
2	S38°14'2"E	29.18'	2	S19°27'0"E	48.42'	2	N64°43'44"E	110.40'
3	S65°46'14"W	134.26'	3	S53°26'19"W	10.41'	3	S72°35'27"E	277.79'
4	S40°2'40"E	88.16'	4	S27°23'37"E	12.89'	4	S64°3'14"E	258.72'
5	N53°44'42"E	190.86'	5	N65°26'20"E	8.44'	5	N15°4'7"E	24.05'
6	S36°52'12"E	20.83'	6	S32°39'20"E	10.74'	6	N64°16'31"W	262.48'
7	N52°29'26"E	410.58'	7	N64°51'13"E	123.65'	7	N72°10'23"W	331.18'
8	S38°32'28"E	157.15'				8	N45°45'53"W	17.8'
9	N52°5'41"E	115.30'						
10	N39°32'33"W	195.11'						
11	N52°4'18"W	2039.96'						

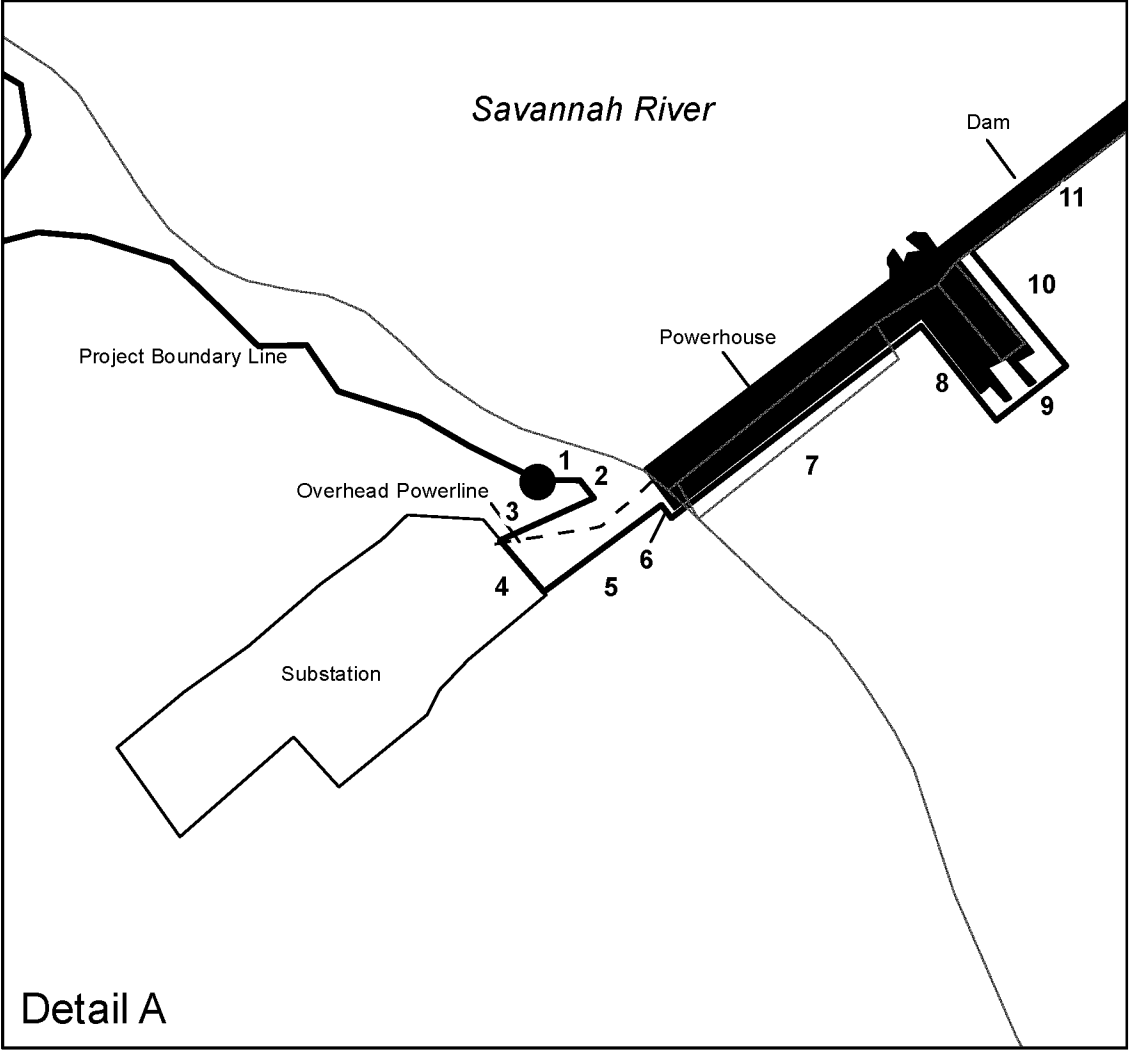
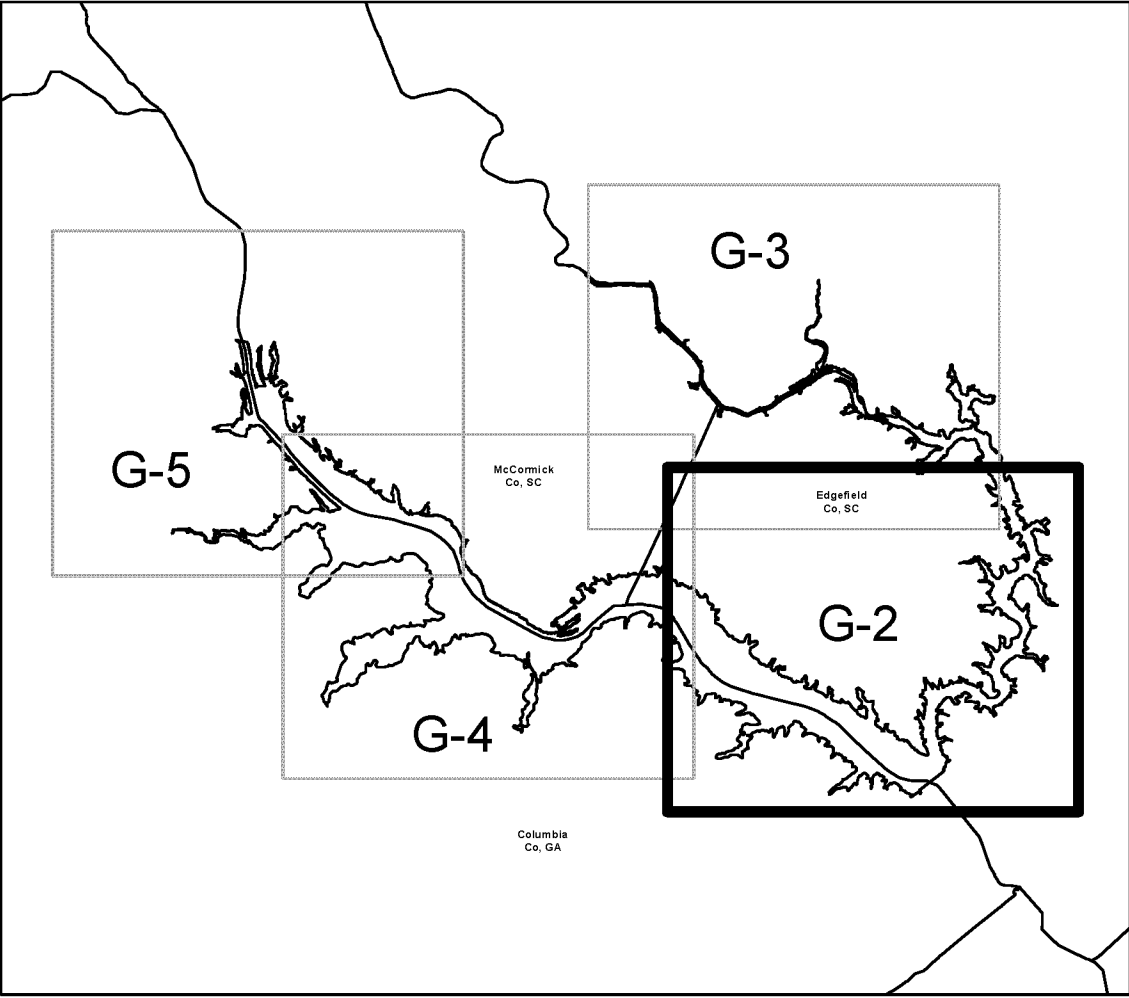
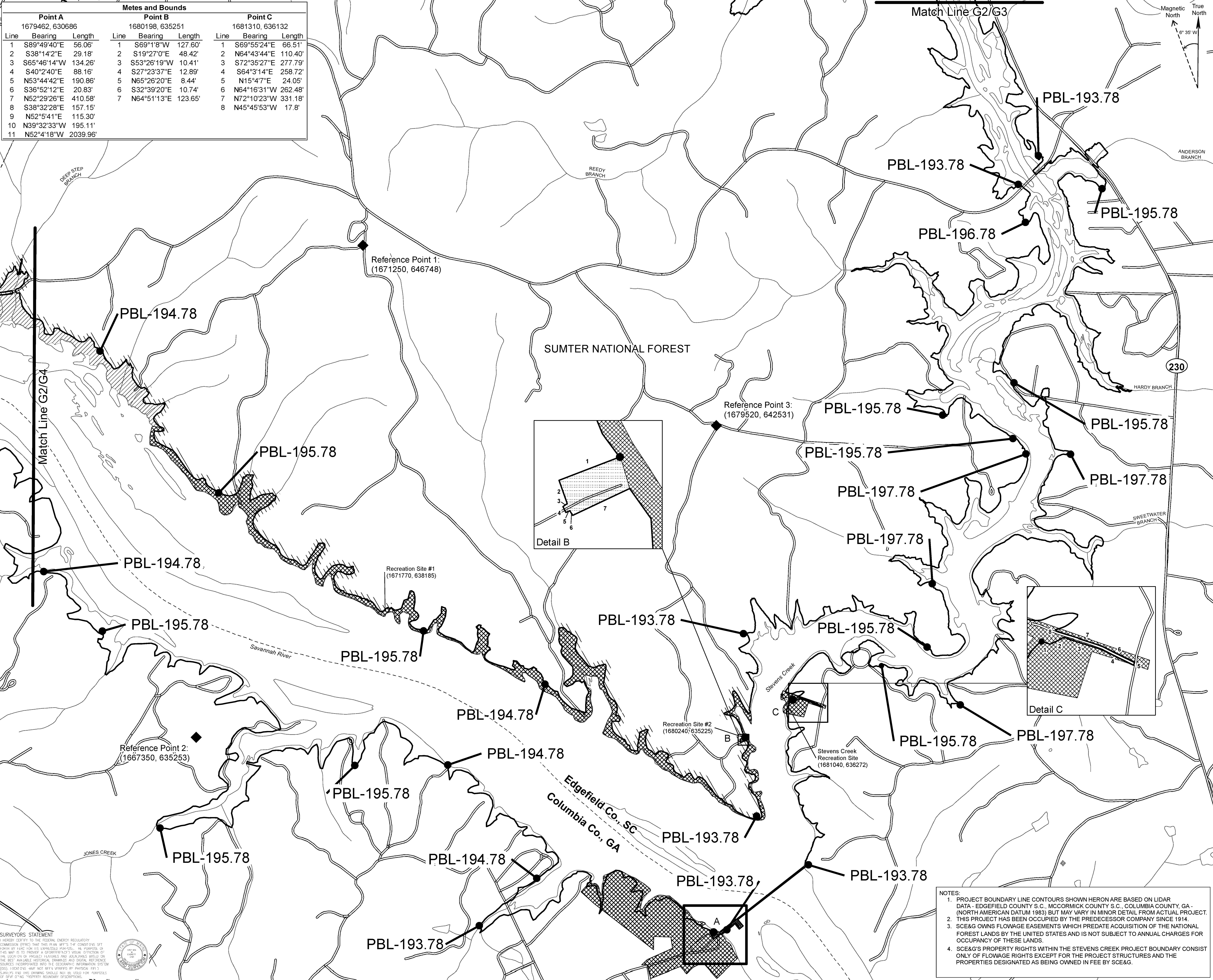

- Project Boundary Line
- Property owned in fee by SCE&G
- USFS Land within PBL (without pre-existing easement)
- USFS Land Within PBL (with pre-existing easement)
- USFS Land Adjacent to PBL

Coordinate System: NAD 1983 NRS2007 StatePlane South Carolina FIPS 3900 Ft Intl
All elevations are in NAVD83.

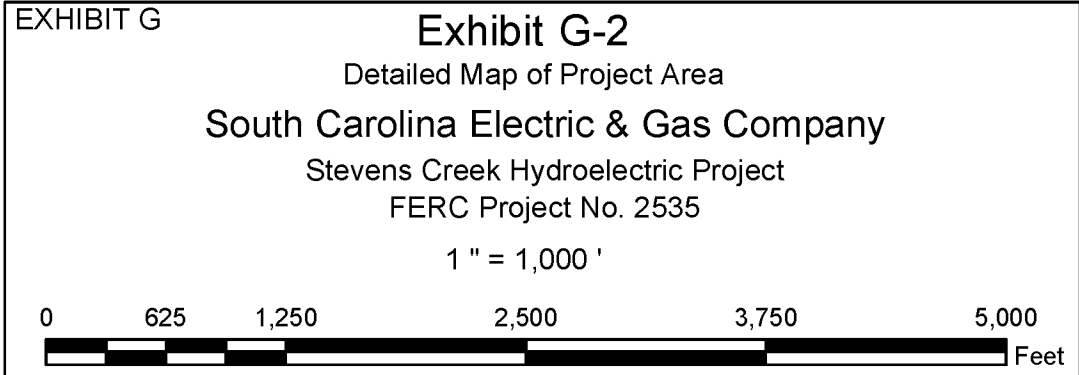

- NOTES:
- PROJECT BOUNDARY LINE CONTOURS SHOWN HEREON ARE BASED ON LIDAR DATA - EDGEFIELD COUNTY S.C., MCCORMICK COUNTY S.C., COLUMBIA COUNTY, GA - (NORTH AMERICAN DATUM 1983) BUT MAY VARY IN MINOR DETAIL FROM ACTUAL PROJECT. THIS PROJECT HAS BEEN OCCUPIED BY THE PREDECESSOR COMPANY SINCE 1914.
 - SCE&G OWNS FLOWAGE EASEMENTS WHICH PREDATE ACQUISITION OF THE NATIONAL FOREST LANDS BY THE UNITED STATES AND IS NOT SUBJECT TO ANNUAL CHARGES FOR OCCUPANCY OF THESE LANDS.
 - SCE&G'S PROPERTY RIGHTS WITHIN THE STEVENS CREEK PROJECT BOUNDARY CONSIST ONLY OF FLOWAGE RIGHTS EXCEPT FOR THE PROJECT STRUCTURES AND THE PROPERTIES DESIGNATED AS BEING OWNED IN FEE BY SCE&G.

Path: G:_Client_Data\SCE&G\Stevens Creek_MXD\Stevens Creek PBL.mxd

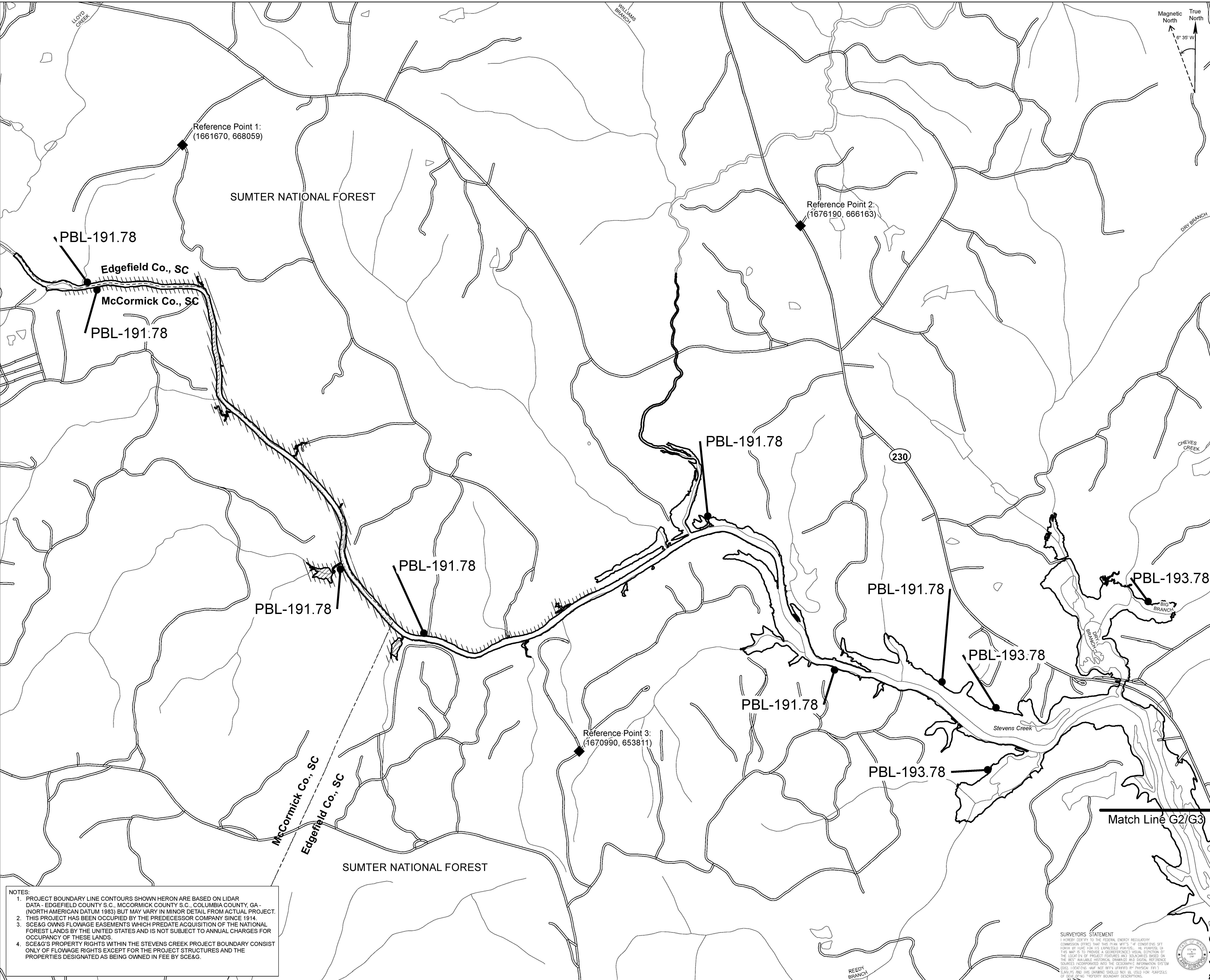

NOTES:
1. PROJECT BOUNDARY LINE CONTOURS SHOWN HEREON ARE BASED ON LIDAR DATA - EDGEFIELD COUNTY S.C., MCCORMICK COUNTY S.C., COLUMBIA COUNTY, GA - (NORTH AMERICAN DATUM 1983) BUT MAY VARY IN MINOR DETAIL FROM ACTUAL PROJECT.
2. THIS PROJECT HAS BEEN OCCUPIED BY THE PREDECESSOR COMPANY SINCE 1914.
3. SCE&G OWNS FLOWAGE EASEMENTS WHICH PREDATE ACQUISITION OF THE NATIONAL FOREST LANDS BY THE UNITED STATES AND IS NOT SUBJECT TO ANNUAL CHARGES FOR OCCUPANCY OF THESE LANDS.
4. SCE&G'S PROPERTY RIGHTS WITHIN THE STEVENS CREEK PROJECT BOUNDARY CONSIST ONLY OF FLOWAGE RIGHTS EXCEPT FOR THE PROJECT STRUCTURES AND THE PROPERTIES DESIGNATED AS BEING OWNED IN FEE BY SCE&G.

SURVEYORS STATEMENT
I HEREBY CERTIFY TO THE FEDERAL ENERGY REGULATORY COMMISSION (FERC) THAT THIS PLAN, MAP, OR CONTINUOUS SET THEREOF IS THE BEST AVAILABLE INFORMATION FOR THE LOCATION OF PROJECT FEATURES AND SOLICITATIONS BASED ON THE BEST AVAILABLE HISTORICAL DRAWINGS AND DIGITAL REFERENCE SOURCES INCORPORATED INTO THE GEOGRAPHIC INFORMATION SYSTEM (GIS) LOCATIONS MAP NOT REVIEWED BY PHYSICAL INSPECTION AND THIS DRAWING SHOULD NOT BE USED FOR PURPOSES OF DETERMINING PROPERTY BOUNDARY DESCRIPTIONS.

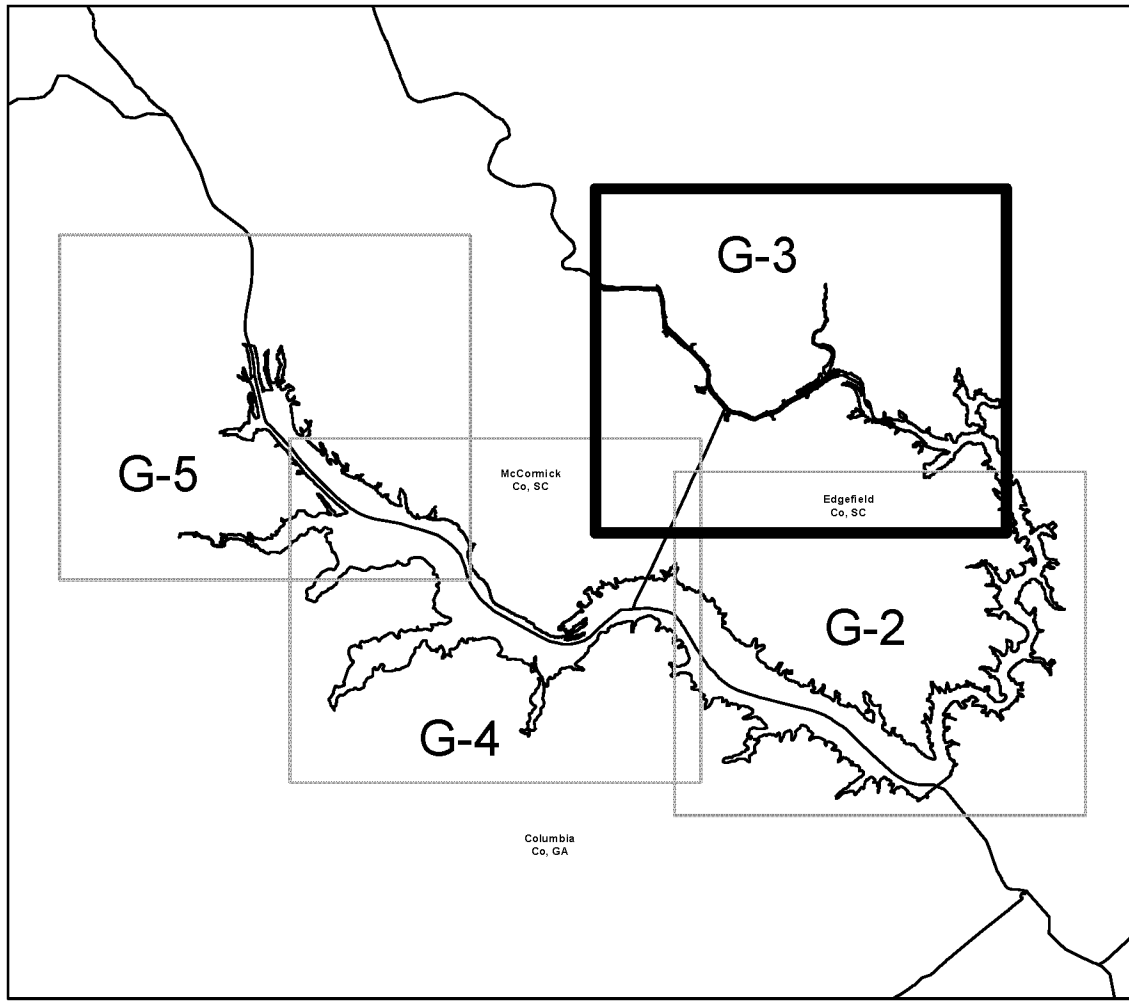

- Project Boundary Line
- Property owned in fee by SCE&G
- USFS Land within PBL (without pre-existing easement)
- USFS Land Within PBL (with pre-existing easement)
- USFS Land Adjacent to PBL

Coordinate System: NAD 1983 NRS2007 StatePlane: South Carolina FIPS 3900 F1 Intl
All elevations are in NAVD83.

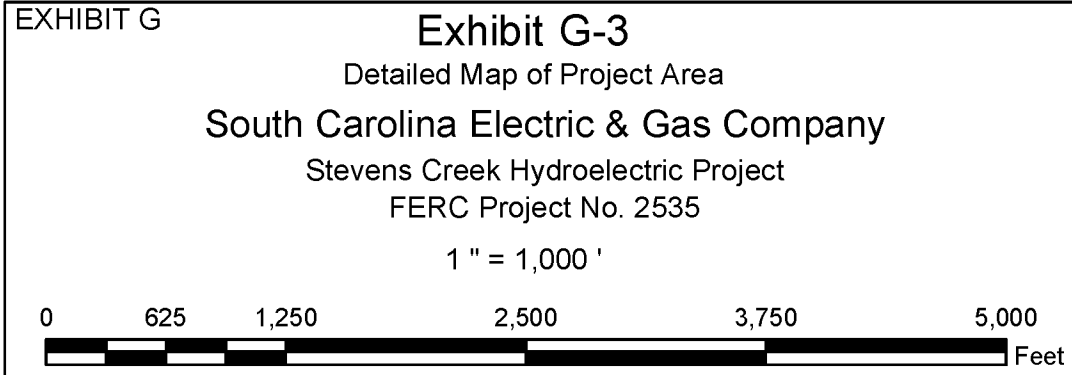

Path: G:_Client_Data\SCE&G\Stevens Creek_MXD\Stevens Creek PBL.mxd

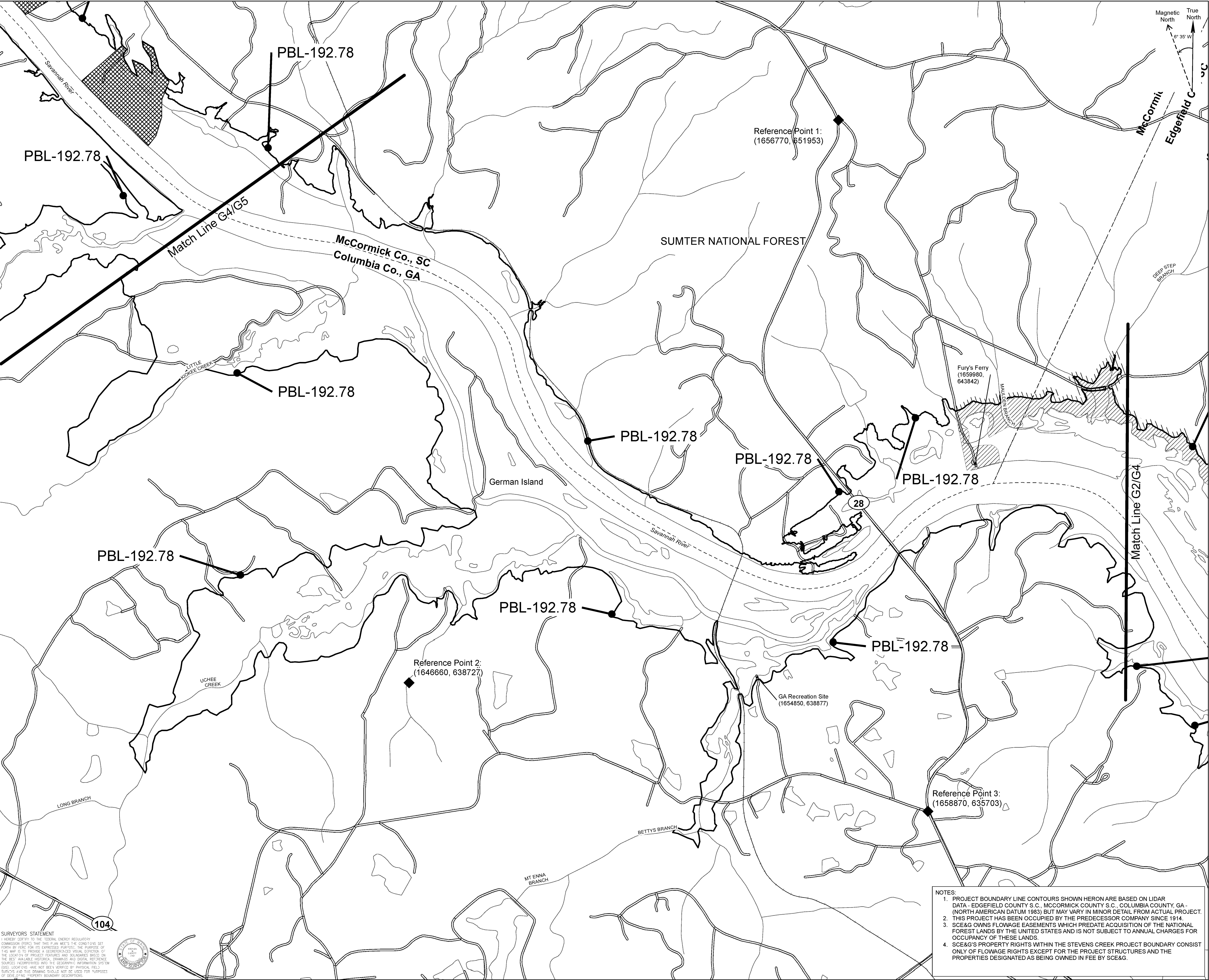

SURVEYOR'S STATEMENT
I HEREBY CERTIFY TO THE FEDERAL ENERGY REGULATORY COMMISSION (FERC) THAT THIS PLAN MEETS THE CONTOUR SET FORTH BY FERC FOR ITS EXPRESSED PURPOSE. THE PURPOSE OF THIS MAP IS TO PROVIDE A GEOGRAPHIC VIEW OF THE LOCATION OF PROJECT FEATURES AND SQUARES BASED ON THE BEST AVAILABLE HISTORICAL, DRAWING AND DIGITAL REFERENCE SOURCES INCORPORATED INTO THE GEOGRAPHIC INFORMATION SYSTEM (GIS). LOCATIONS HAVE NOT BEEN VERIFIED BY PHYSICAL FIELD SURVEYS AND THIS DRAWING SHOULD NOT BE USED FOR PURPOSES OF DEED, ZONING OR PROPERTY BOUNDARY DESCRIPTIONS.



NOTES:
1. PROJECT BOUNDARY LINE CONTOURS SHOWN HEREON ARE BASED ON LIDAR DATA - EDGEFIELD COUNTY S.C., MCCORMICK COUNTY S.C., COLUMBIA COUNTY, GA - (NORTH AMERICAN DATUM 1983) BUT MAY VARY IN MINOR DETAIL FROM ACTUAL PROJECT.
2. THIS PROJECT HAS BEEN OCCUPIED BY THE PREDECESSOR COMPANY SINCE 1914.
3. SCE&G OWNS FLOWAGE EASEMENTS WHICH PREDATE ACQUISITION OF THE NATIONAL FOREST LANDS BY THE UNITED STATES AND IS NOT SUBJECT TO ANNUAL CHARGES FOR OCCUPANCY OF THESE LANDS.
4. SCE&G'S PROPERTY RIGHTS WITHIN THE STEVENS CREEK PROJECT BOUNDARY CONSIST ONLY OF FLOWAGE RIGHTS EXCEPT FOR THE PROJECT STRUCTURES AND THE PROPERTIES DESIGNATED AS BEING OWNED IN FEE BY SCE&G.

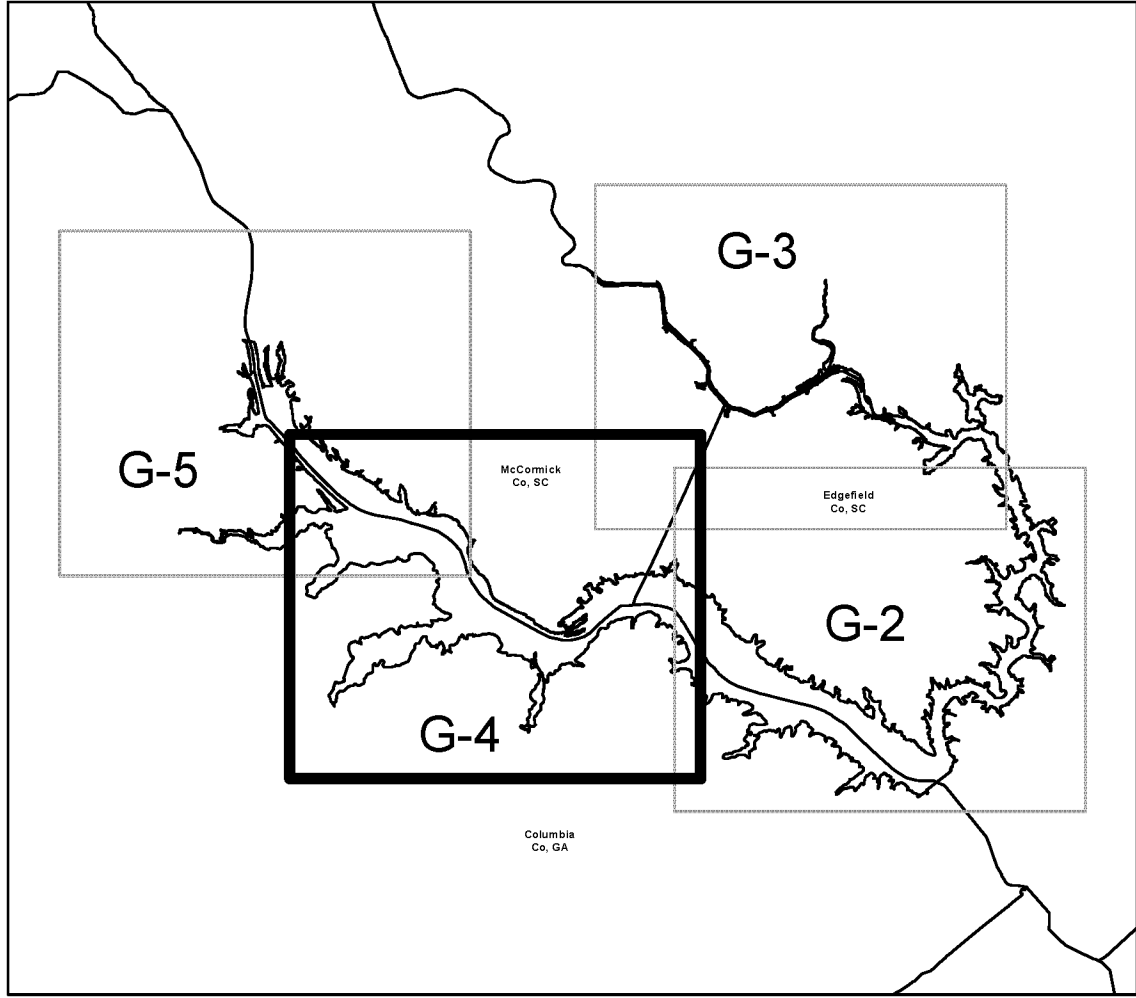

- Project Boundary Line
- Property owned in fee by SCE&G
- USFS Land within PBL (without pre-existing easement)
- USFS Land Within PBL (with pre-existing easement)
- USFS Land Adjacent to PBL

Coordinate System: NAD 1983 NRS2007 StatePlane: South Carolina FIPS 3900 Ft Intl
All elevations are in NAVD83.

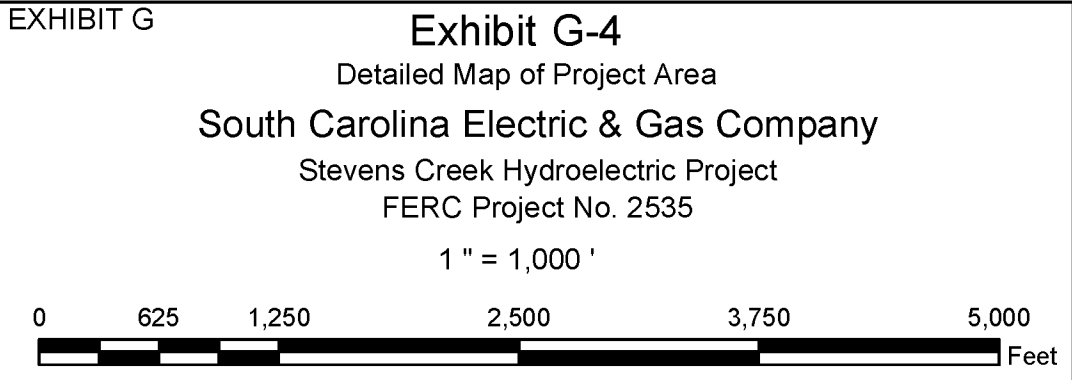
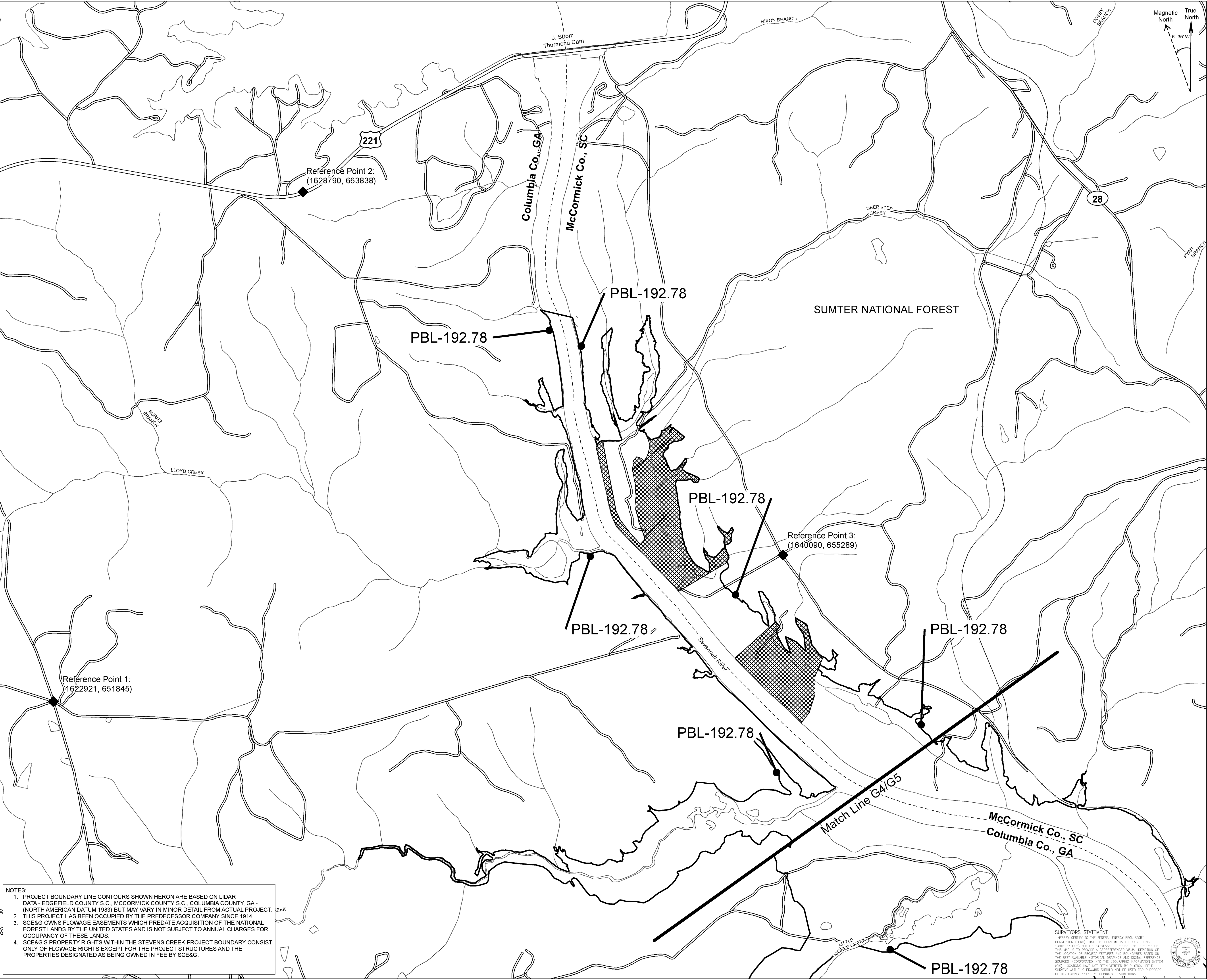

EXHIBIT G

P-2535-26

Path: G:_Client_Data\SCE&G\Stevens Creek_MXD\Stevens Creek PBL.mxd



NOTES:
1. PROJECT BOUNDARY LINE CONTOURS SHOWN HEREON ARE BASED ON LIDAR DATA - EDGEFIELD COUNTY S.C., MCCORMICK COUNTY S.C., COLUMBIA COUNTY, GA - (NORTH AMERICAN DATUM 1983) BUT MAY VARY IN MINOR DETAIL FROM ACTUAL PROJECT.
2. THIS PROJECT HAS BEEN OCCUPIED BY THE PREDECESSOR COMPANY SINCE 1914.
3. SCE&G OWNS FLOWAGE EASEMENTS WHICH PREDATE ACQUISITION OF THE NATIONAL FOREST LANDS BY THE UNITED STATES AND IS NOT SUBJECT TO ANNUAL CHARGES FOR OCCUPANCY OF THESE LANDS.
4. SCE&G'S PROPERTY RIGHTS WITHIN THE STEVENS CREEK PROJECT BOUNDARY CONSIST ONLY OF FLOWAGE RIGHTS EXCEPT FOR THE PROJECT STRUCTURES AND THE PROPERTIES DESIGNATED AS BEING OWNED IN FEE BY SCE&G.

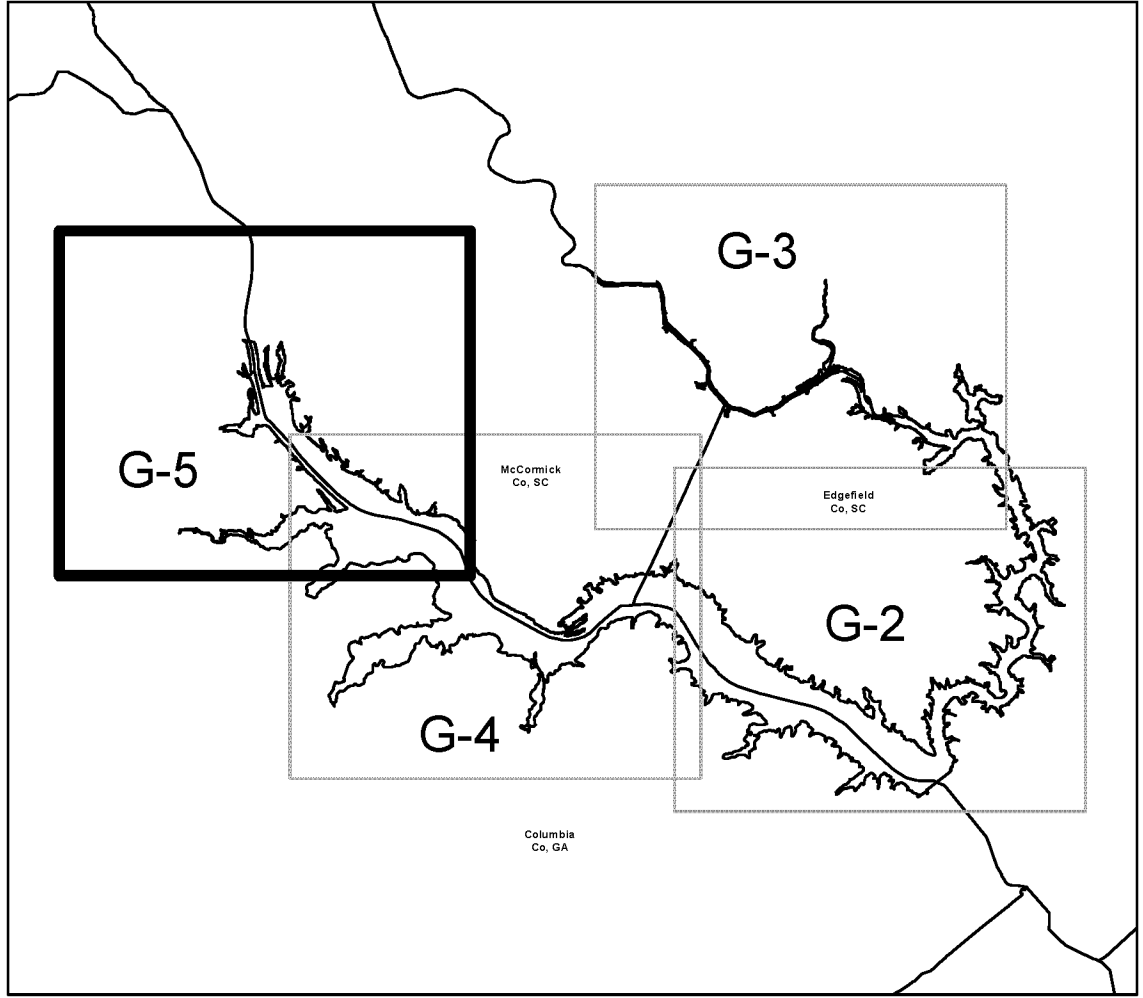

- Project Boundary Line
- Property owned in fee by SCE&G
- USFS Land within PBL (without pre-existing easement)
- USFS Land Within PBL (with pre-existing easement)
- USFS Land Adjacent to PBL

Coordinate System: NAD 1983 NRS2007 StatePlane: South Carolina FIPS 3900 F1 Intl
All elevations are in NAVD83.

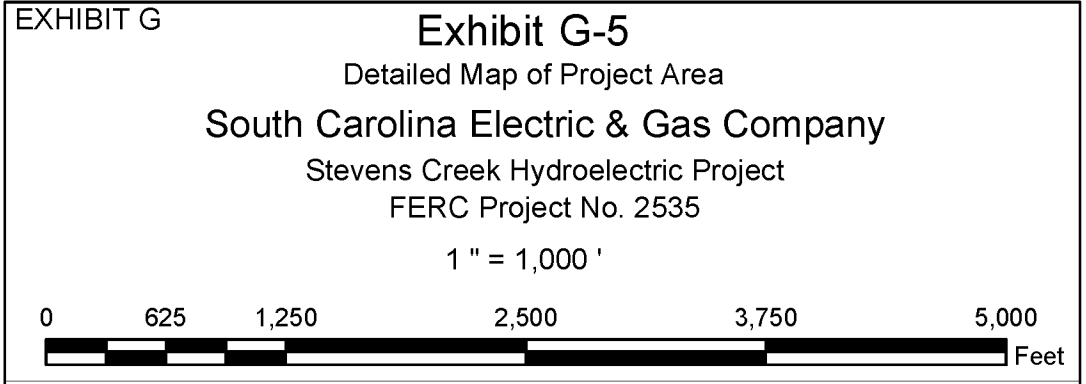

SURVEYORS STATEMENT
HEREBY CERTIFY TO THE FEDERAL ENERGY REGULATORY COMMISSION (FERC) THAT THIS PLAN MEETS THE CONDITIONS SET FORTH BY FERC FOR ITS EXPRESSED PURPOSE. THE PURPOSE OF THIS MAP IS TO PROVIDE A CORRELATED VISUAL DEPICTION OF THE LOCATION OF PROJECT FEATURES AND BOUNDARIES BASED ON THE BEST AVAILABLE - HISTORICAL, DRAWINGS AND DIGITAL REFERENCE SOURCES INCORPORATED INTO THE GEOGRAPHIC INFORMATION SYSTEM (GIS). LOCATIONS HAVE NOT BEEN VERIFIED BY PHYSICAL FIELD SURVEYS AND THIS DRAWING SHOULD NOT BE USED FOR PURPOSES OF DEVELOPING PROPERTY BOUNDARY DESCRIPTIONS.

