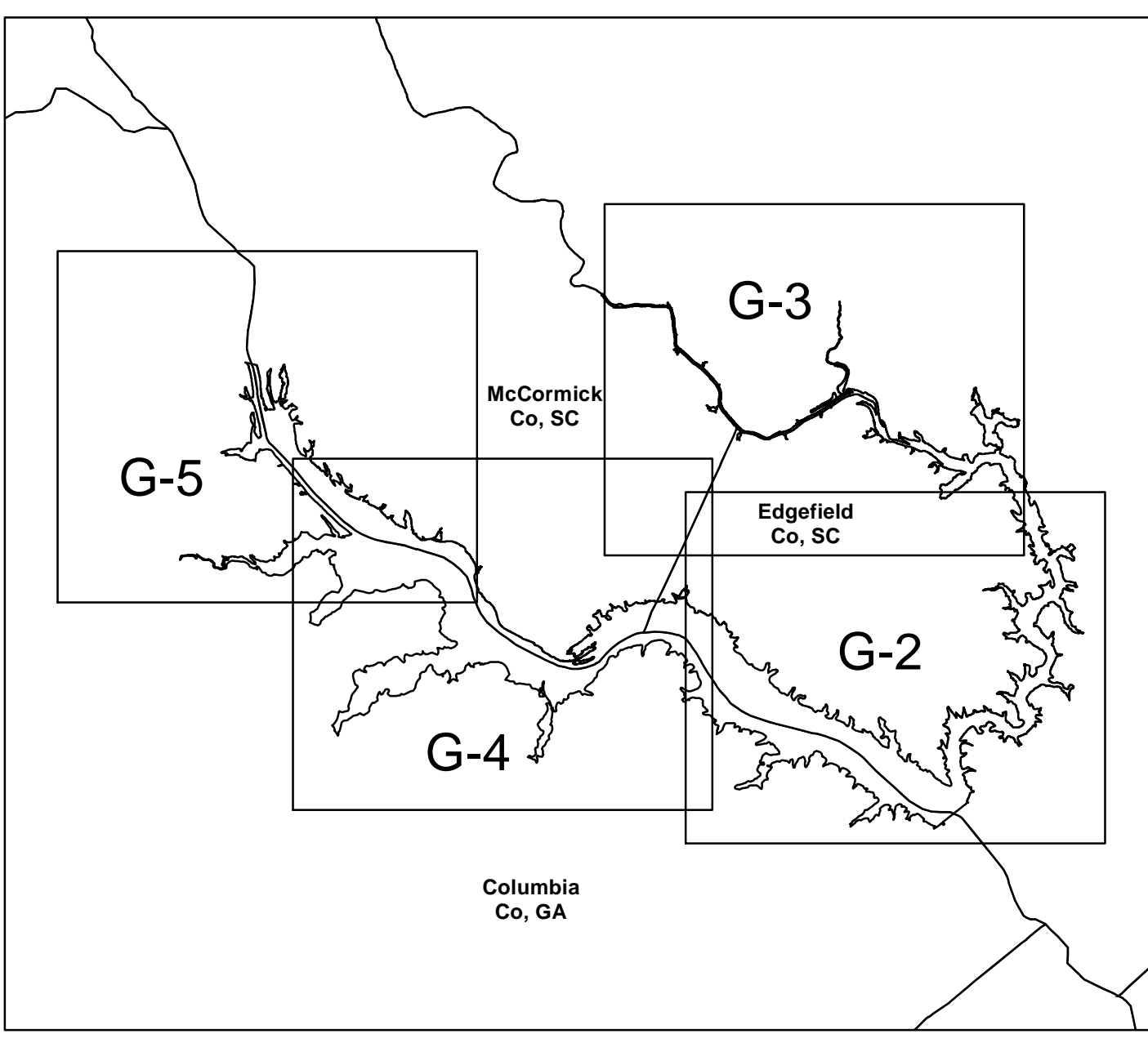
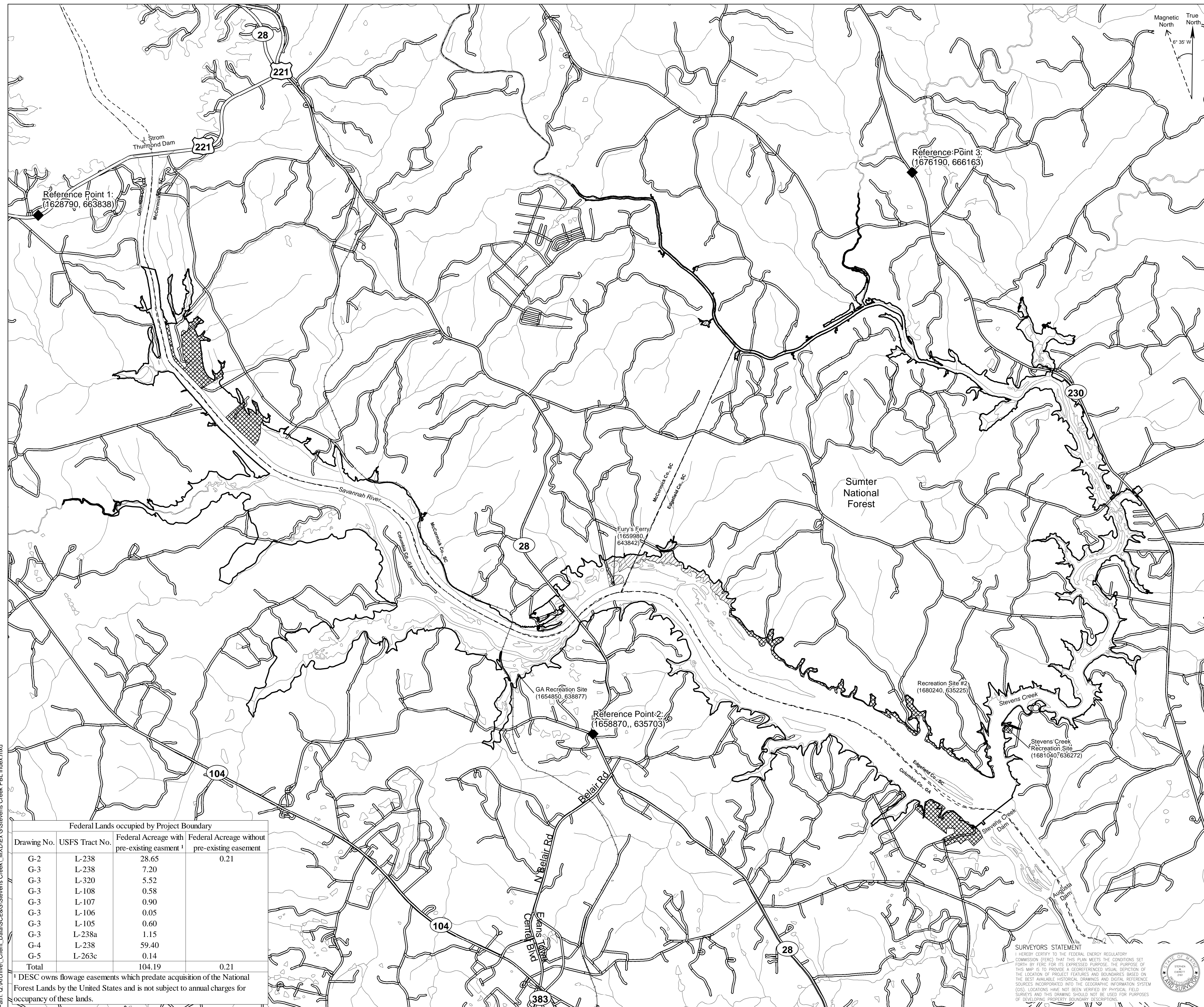

EXHIBIT G

PROJECT BOUNDARY MAPS



- Project Boundary Line
- ▨ Property owned in fee by DESC
- ▤ USFS Land within PBL (without pre-existing easement)
- ▥ USFS Land Within PBL (with pre-existing easement)

Note:

1. DESC owns flowage easements which predate acquisition of the National Forest Lands by the United States and is not subject to annual charges for occupancy of these lands.
2. DESC's property rights within the Stevens Creek Project Boundary consist only of flowage rights except for the project structures and the properties designated as being owned in fee by DESC.

Coordinate System: NAD 1983 NSRS2007 StatePlane South Carolina FIPS 3900 Ft Intl
All elevations are in NAV88.

Federal Lands occupied by Project Boundary			
Drawing No.	USFS Tract No.	Federal Acreage with pre-existing easment †	Federal Acreage without pre-existing easement
G-2	L-238	28.65	0.21
G-3	L-238	7.20	
G-3	L-320	5.52	
G-3	L-108	0.58	
G-3	L-107	0.90	
G-3	L-106	0.05	
G-3	L-105	0.60	
G-3	L-238a	1.15	
G-4	L-238	59.40	
G-5	L-263c	0.14	
Total		104.19	0.21

† DESC owns flowage easements which predate acquisition of the National Forest Lands by the United States and is not subject to annual charges for occupancy of these lands.

SURVEYORS STATEMENT
I HEREBY CERTIFY TO THE FEDERAL ENERGY REGULATORY COMMISSION (FERC) THAT THIS PLAN MEETS THE CONDITIONS SET FORTH BY FERC FOR ITS EXPRESSED PURPOSE. THE PURPOSE OF THIS MAP IS TO PROVIDE A GOREFERENCED VISUAL DEPICTION OF THE LOCATION OF PROJECT FEATURES AND BOUNDARIES BASED ON THE BEST AVAILABLE HISTORICAL DRAWINGS AND DIGITAL REFERENCE SOURCES INCORPORATED INTO THE GEOGRAPHIC INFORMATION SYSTEM (GIS). LOCATIONS HAVE NOT BEEN IDENTIFIED BY PHYSICAL FIELD SURVEYS AND THIS DRAWING SHOULD NOT BE USED FOR PURPOSES OF DEVELOPING PROPERTY BOUNDARY DESCRIPTIONS.



EXHIBIT G

Exhibit G-1
General Map of Project Area
Dominion Energy South Carolina, Inc.
Stevens Creek Hydroelectric Project
FERC Project No. 2535
1" = 2,370'

Point A			Point B			Point C		
Line	Bearing	Length	Line	Bearing	Length	Line	Bearing	Length
1	S89°49'40"E	56.06'	1	S69°18'W	127.60'	1	S69°55'24"E	66.51'
2	S38°14'2"E	29.18'	2	S19°27'0"E	48.42'	2	N64°43'44"E	110.40'
3	S65°46'14"W	134.26'	3	S53°26'19"W	10.41'	3	S72°35'27"E	277.79'
4	S40°2'40"E	88.16'	4	S27°23'37"E	12.89'	4	S64°3'14"E	258.72'
5	N53°44'42"E	190.86'	5	N65°26'20"E	8.44'	5	N15°4'7"E	24.05'
6	S36°52'12"E	20.83'	6	S32°39'20"E	10.74'	6	N64°16'31"W	262.48'
7	N52°29'26"E	410.58'	7	N64°51'13"E	123.65'	7	N72°10'23"W	331.18'
8	S38°32'28"E	157.15'				8	N45°45'53"W	17.8'
9	N52°5'41"E	115.30'						
10	N39°32'33"W	195.11'						
11	N52°4'18"W	2039.96'						

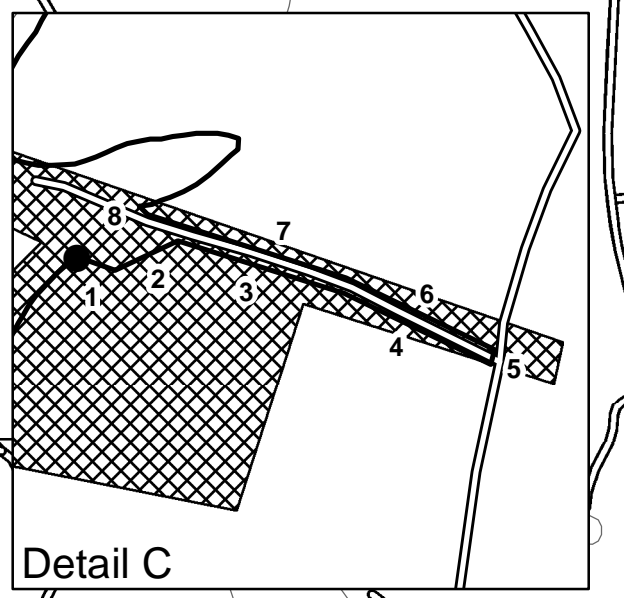
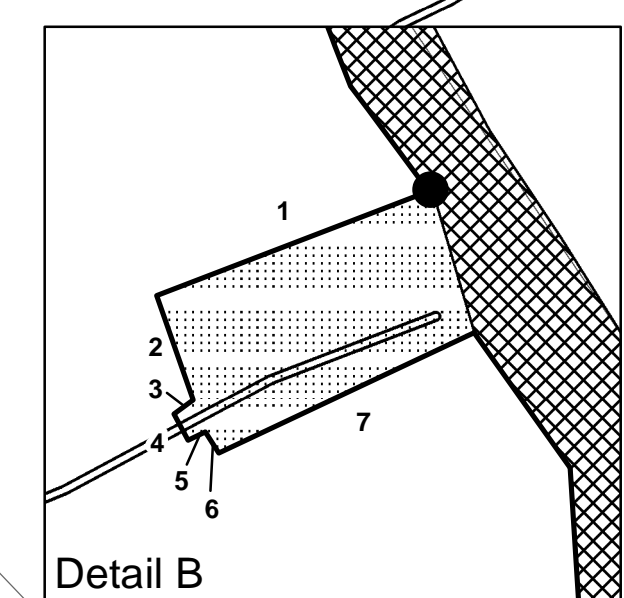
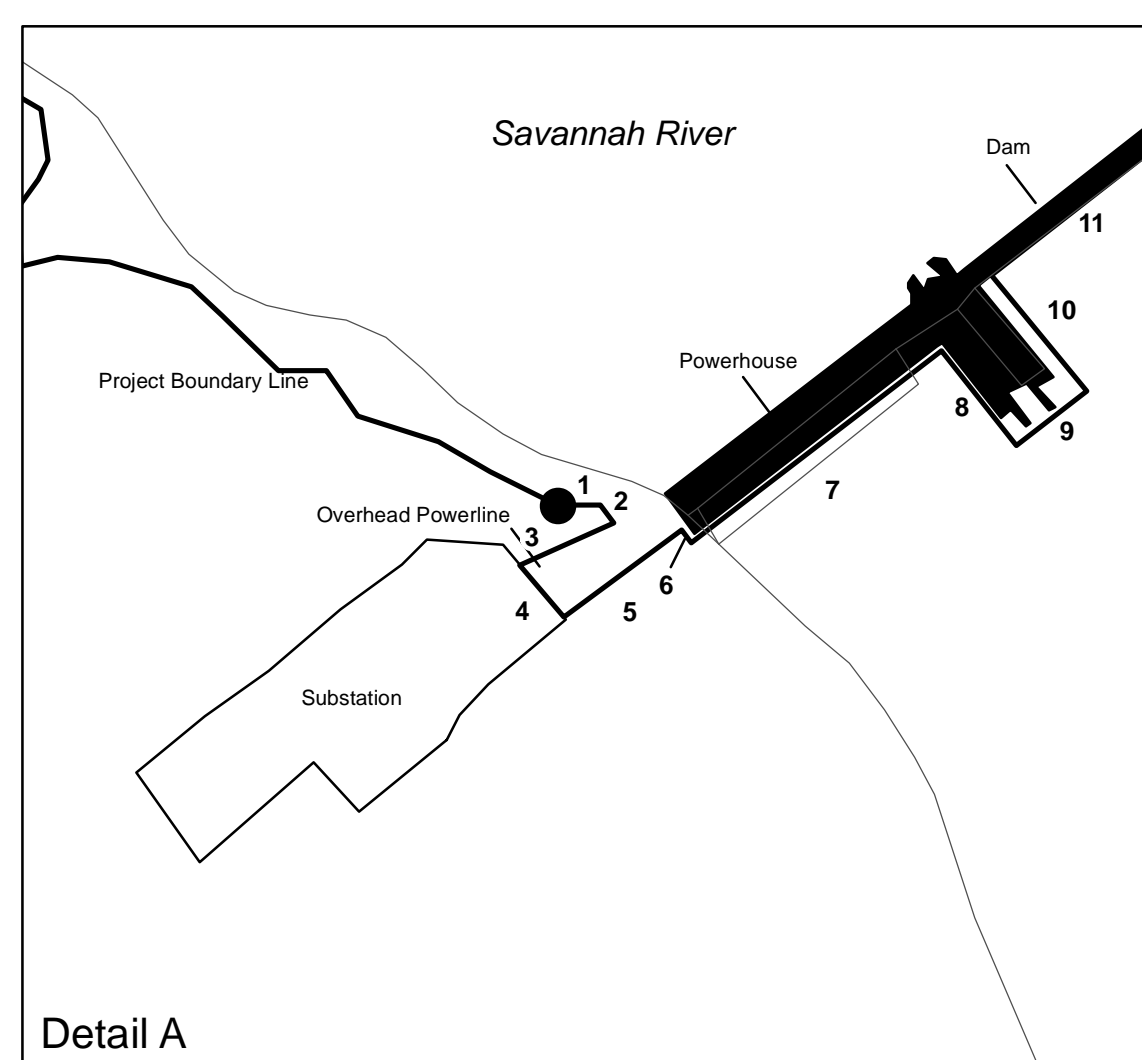
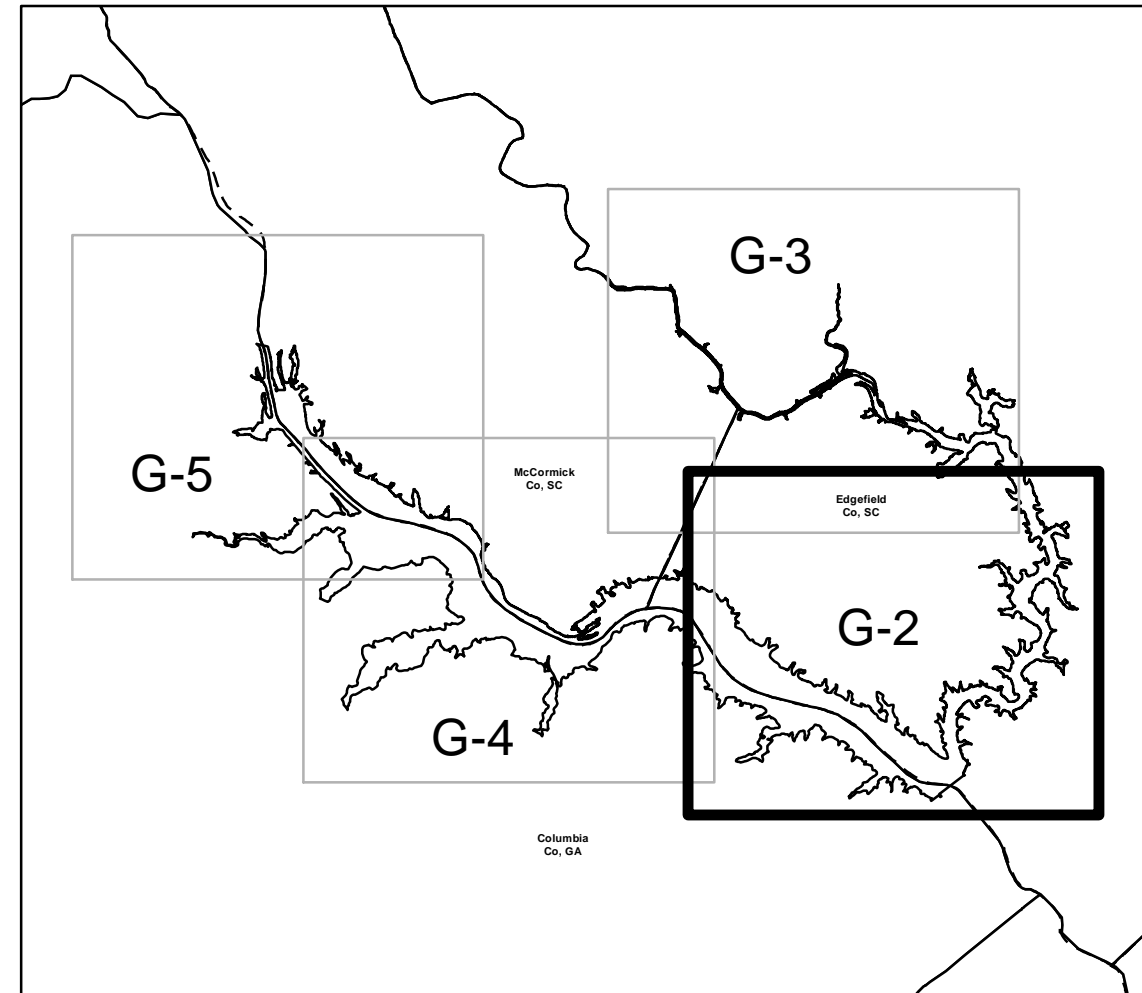
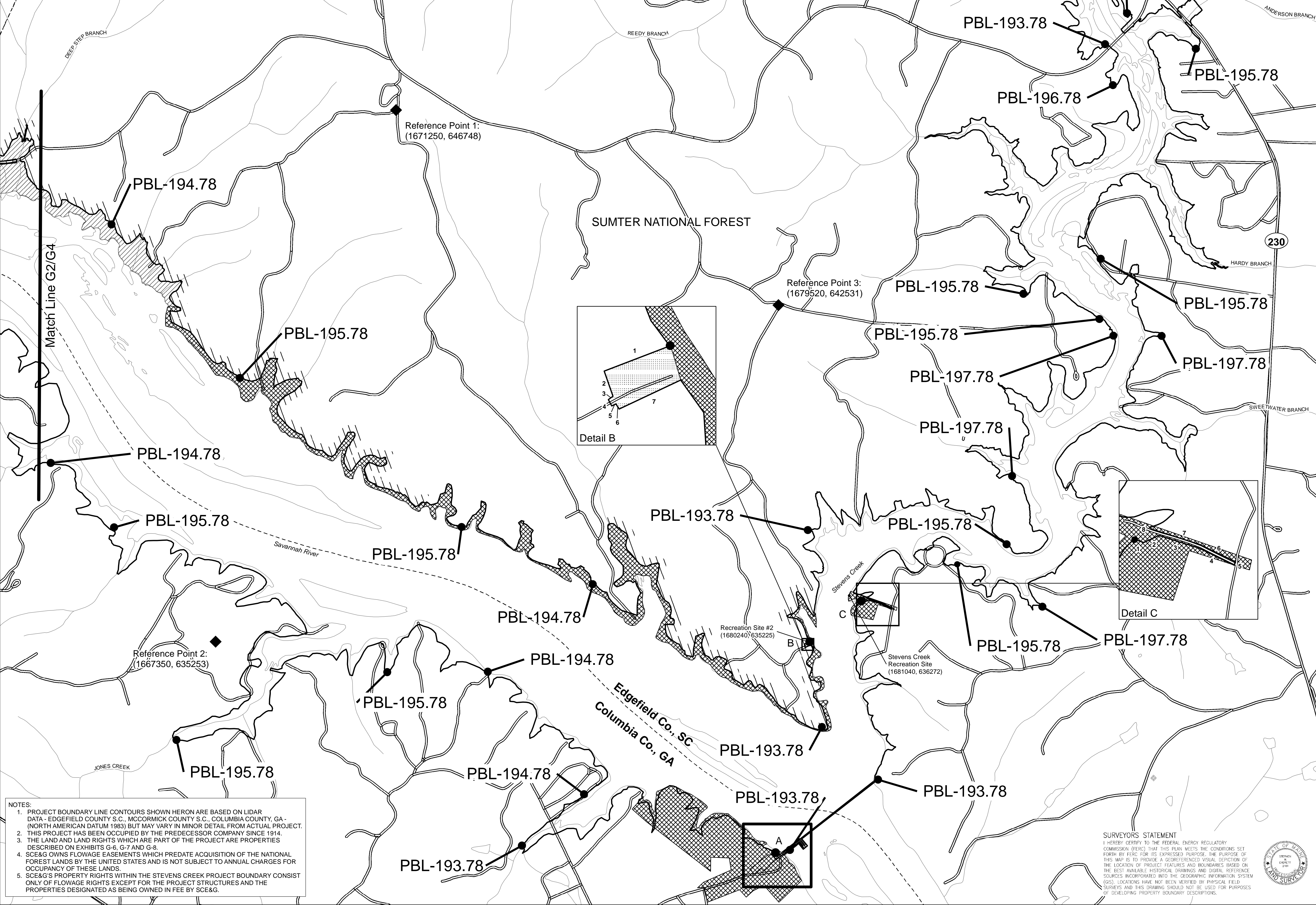

NOTES:

- PROJECT BOUNDARY LINE CONTOURS SHOWN HEREON ARE BASED ON LIDAR DATA - EDGEFIELD COUNTY S.C., MCCORMICK COUNTY S.C., COLUMBIA COUNTY, GA. (NORTH AMERICAN DATUM 1983) BUT MAY VARY IN MINOR DETAIL FROM ACTUAL PROJECT.
- THIS PROJECT HAS BEEN OCCUPIED BY THE PREDECESSOR COMPANY SINCE 1914.
- THE LAND AND LAND RIGHTS WHICH ARE PART OF THE PROJECT ARE PROPERTIES DESCRIBED ON EXHIBITS G-6, G-7 AND G-8.
- SCE&G OWNS FLOWAGE EASEMENTS WHICH PREDATE ACQUISITION OF THE NATIONAL FOREST LANDS BY THE UNITED STATES AND IS NOT SUBJECT TO ANNUAL CHARGES FOR OCCUPANCY OF THESE LANDS.
- SCE&G'S PROPERTY RIGHTS WITHIN THE STEVENS CREEK PROJECT BOUNDARY CONSIST ONLY OF FLOWAGE RIGHTS EXCEPT FOR THE PROJECT STRUCTURES AND THE PROPERTIES DESIGNATED AS BEING OWNED IN FEE BY SCE&G.

SURVEYORS STATEMENT
 I HEREBY CERTIFY TO THE FEDERAL ENERGY REGULATORY COMMISSION (FERC) THAT THIS PLAN MEETS THE CONDITIONS SET FORTH BY FERC FOR ITS EXPRESSED PURPOSE. THE PURPOSE OF THIS MAP IS TO PROVIDE A GEOREFERENCED VISUAL DEPICTION OF THE LOCATION OF PROJECT FEATURES AND BOUNDARIES BASED ON THE BEST AVAILABLE HISTORICAL DRAWINGS AND DIGITAL REFERENCE SOURCES INCORPORATED INTO THE GEOSPATIAL INFORMATION SYSTEM (GIS). LOCATIONS HAVE NOT BEEN VERIFIED BY PHYSICAL FIELD SURVEYS AND THIS DRAWING SHOULD NOT BE USED FOR PURPOSES OF DEVELOPING PROPERTY BOUNDARY DESCRIPTIONS.

- Project Boundary Line
- ▨ Property owned in fee by DESC
- ▨ USFS Land within PBL (without pre-existing easement)
- ▨ USFS Land Within PBL (with pre-existing easement)
- ▨ USFS Land Adjacent to PBL

Coordinate System: NAD 1983 NRSR2007 StatePlane South Carolina FIPS 3900 Ft Int
 All elevations are in NAVD88.

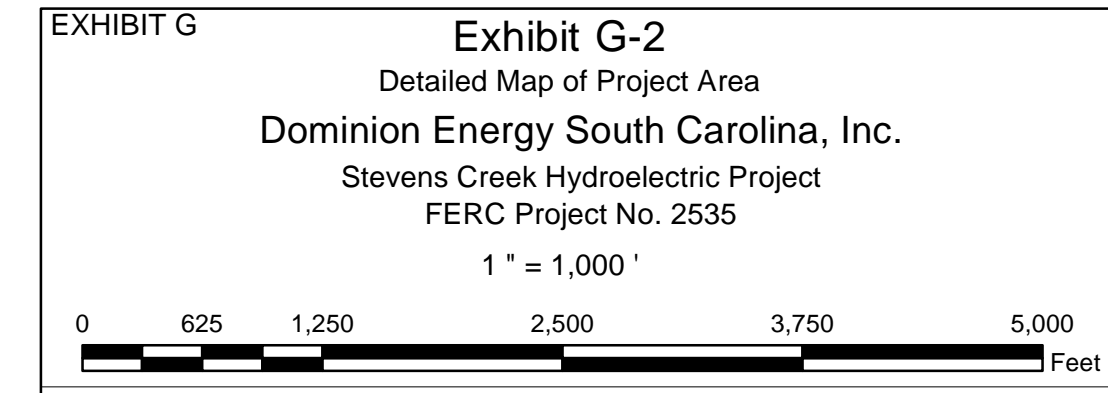

Path: C:\Archives\Client_Data\SC&EG\Stevens Creek\IMD\EX_G\Stevens Creek PBL.mxd

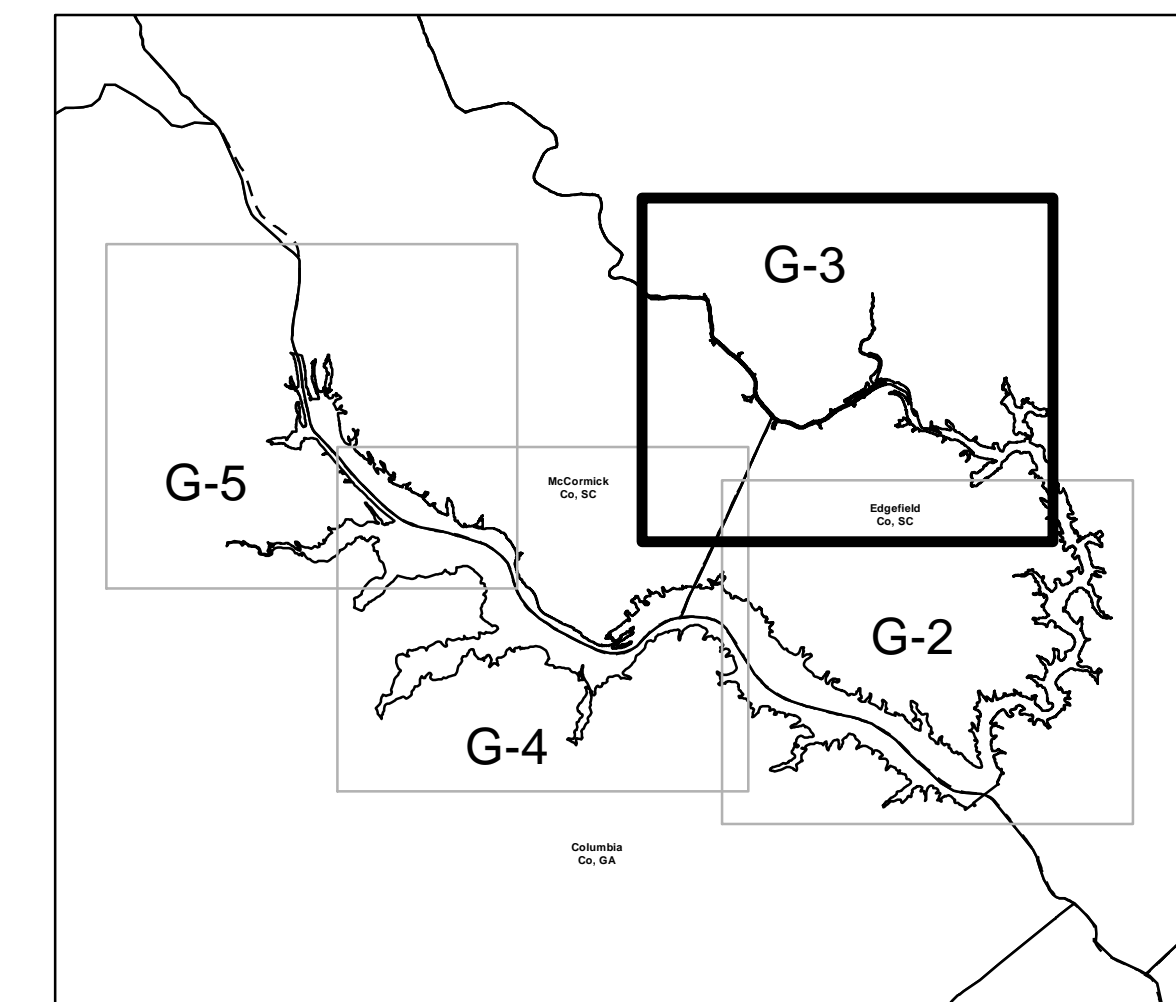
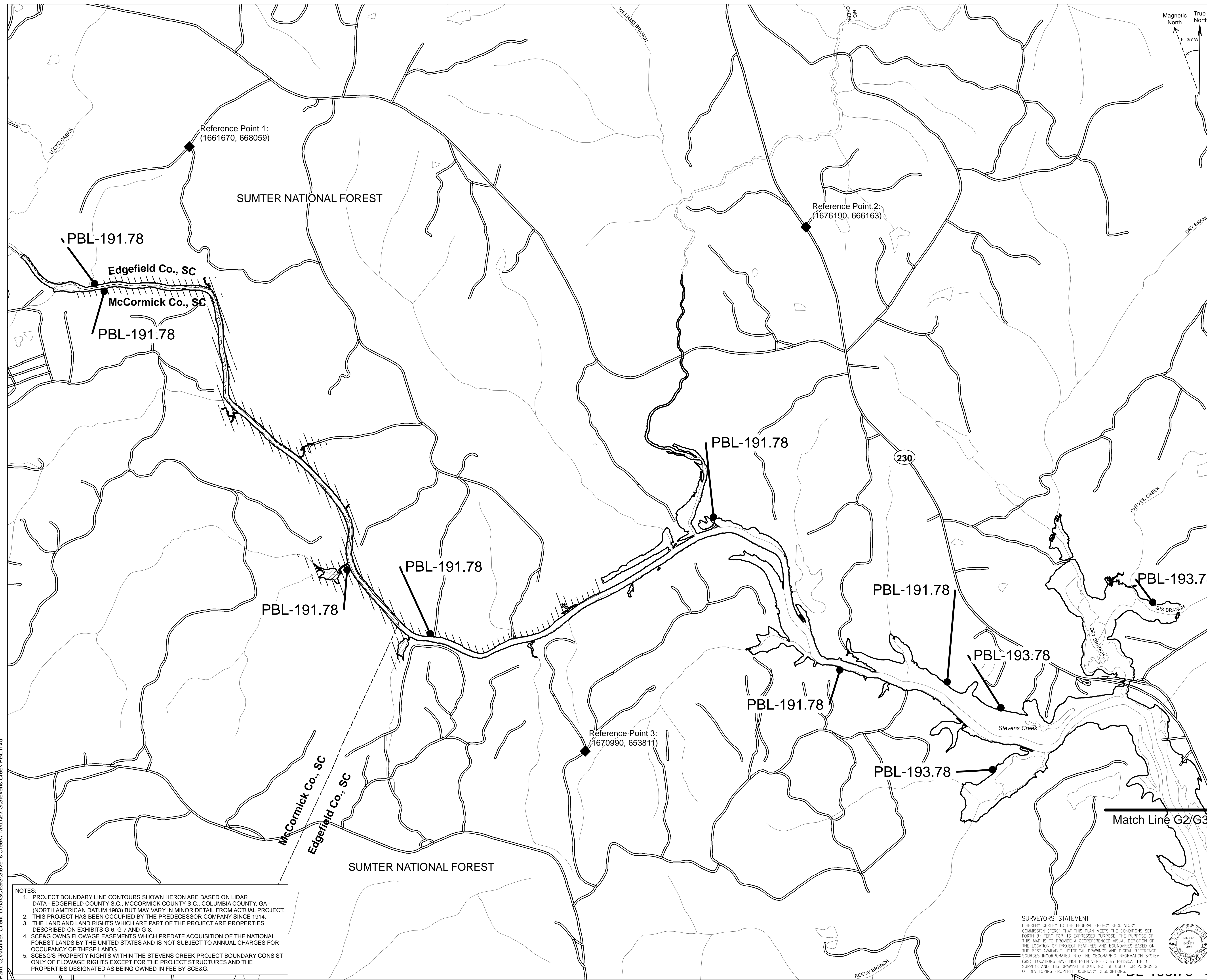

NOTES:

1. PROJECT BOUNDARY LINE CONTOURS SHOWN HEREON ARE BASED ON LIDAR DATA - EDGEFIELD COUNTY S.C., MCCORMICK COUNTY S.C., COLUMBIA COUNTY, GA - (NORTH AMERICAN DATUM 1983) BUT MAY VARY IN MINOR DETAIL FROM ACTUAL PROJECT.
2. THIS PROJECT HAS BEEN OCCUPIED BY THE PREDECESSOR COMPANY SINCE 1914.
3. THE LAND AND LAND RIGHTS WHICH ARE PART OF THE PROJECT ARE PROPERTIES DESCRIBED ON EXHIBITS G-6, G-7 AND G-8.
4. SCE&G OWNS FLOWAGE EASEMENTS WHICH PREDATE ACQUISITION OF THE NATIONAL FOREST LANDS BY THE UNITED STATES AND IS NOT SUBJECT TO ANNUAL CHARGES FOR OCCUPANCY OF THESE LANDS.
5. SCE&G'S PROPERTY RIGHTS WITHIN THE STEVENS CREEK PROJECT BOUNDARY CONSIST ONLY OF FLOWAGE RIGHTS EXCEPT FOR THE PROJECT STRUCTURES AND THE PROPERTIES DESIGNATED AS BEING OWNED IN FEE BY SCE&G.

SURVEYORS STATEMENT
 I HEREBY CERTIFY TO THE FEDERAL ENERGY REGULATORY COMMISSION (FERC) THAT THIS PLAN MEETS THE CONDITIONS SET FORTH BY FERC FOR ITS EXPRESSED PURPOSE. THE PURPOSE OF THIS MAP IS TO PROVIDE A GEOFERENCED VISUAL DEPICTION OF THE LOCATION OF PROJECT FEATURES AND BOUNDARIES BASED ON THE BEST AVAILABLE HISTORICAL DRAWINGS AND DIGITAL REFERENCE SOURCES INCORPORATED INTO THE GEOGRAPHIC INFORMATION SYSTEM (GIS). LOCATIONS HAVE NOT BEEN VERIFIED BY PHYSICAL FIELD SURVEY AND THIS DRAWING SHOULD NOT BE USED FOR PURPOSES OF DEVELOPING PROPERTY BOUNDARY DESCRIPTIONS.

- Project Boundary Line
- ▨ Property owned in fee by DESC
- ▤ USFS Land within PBL (without pre-existing easement)
- ▥ USFS Land Within PBL (with pre-existing easement)
- ▧ USFS Land Adjacent to PBL

Coordinate System: NAD 1983 NRS2007 StatePlane South Carolina FIPS 3900 Ft Intl
 All elevations are in NAVD83.

EXHIBIT G

Exhibit G-3
 Detailed Map of Project Area
 Dominion Energy South Carolina, Inc.
 Stevens Creek Hydroelectric Project
 FERC Project No. 2535
 1" = 1,000'

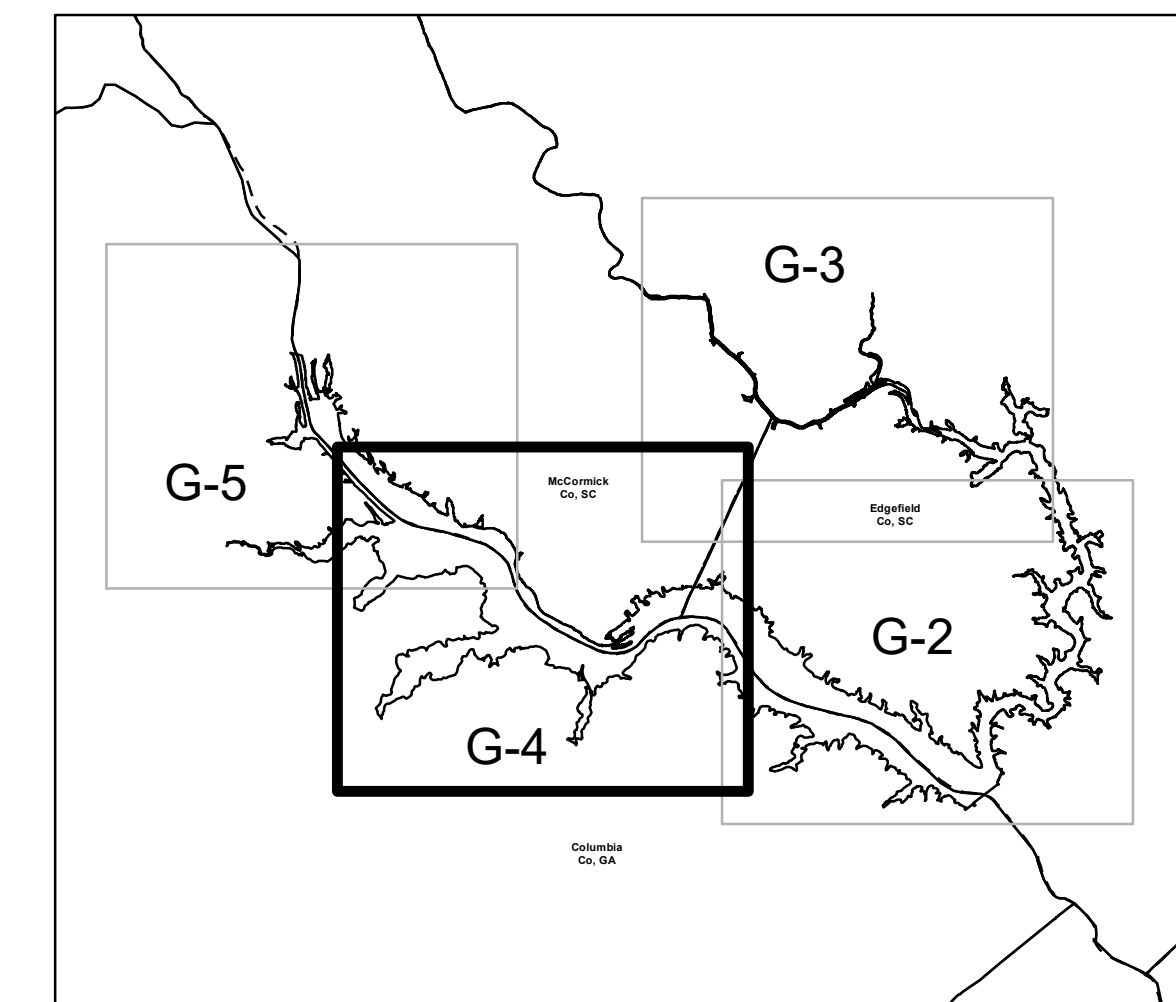
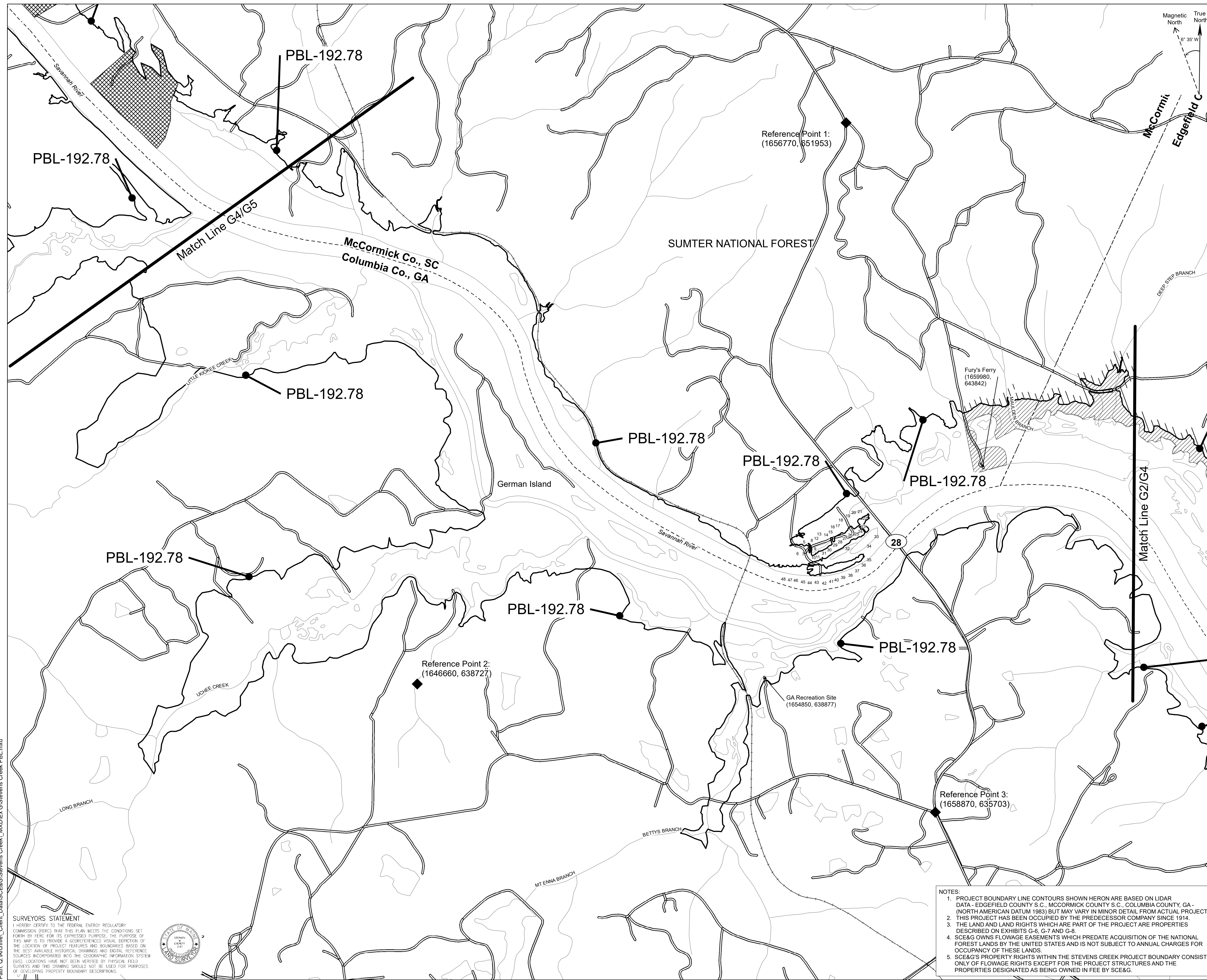

- Project Boundary Line
- ▨ Property owned in fee by DESC
- ▤ USFS Land within PBL (without pre-existing easement)
- ▥ USFS Land Within PBL (with pre-existing easement)
- 〰 USFS Land Adjacent to PBL

Coordinate System: NAD 1983 NRS2007 StatePlane South Carolina FIPS 3900 Ft Int
 All elevations are in NAVD88.

EXHIBIT G **Exhibit G-4**
 Detailed Map of Project Area
Dominion Energy South Carolina, Inc.
 Stevens Creek Hydroelectric Project
 FERC Project No. 2535
 1" = 1,000'

- NOTES:**
1. PROJECT BOUNDARY LINE CONTOURS SHOWN HEREON ARE BASED ON LIDAR DATA - EDGEFIELD COUNTY S.C., MCCORMICK COUNTY S.C., COLUMBIA COUNTY, GA - (NORTH AMERICAN DATUM 1983) BUT MAY VARY IN MINOR DETAIL FROM ACTUAL PROJECT.
 2. THIS PROJECT HAS BEEN OCCUPIED BY THE PREDECESSOR COMPANY SINCE 1914.
 3. THE LAND AND LAND RIGHTS WHICH ARE PART OF THE PROJECT ARE PROPERTIES DESCRIBED ON EXHIBITS G-6, G-7 AND G-8.
 4. SCE&G OWNS FLOWAGE EASEMENTS WHICH PREDATE ACQUISITION OF THE NATIONAL FOREST LANDS BY THE UNITED STATES AND IS NOT SUBJECT TO ANNUAL CHARGES FOR OCCUPANCY OF THESE LANDS.
 5. SCE&G'S PROPERTY RIGHTS WITHIN THE STEVENS CREEK PROJECT BOUNDARY CONSIST ONLY OF FLOWAGE RIGHTS EXCEPT FOR THE PROJECT STRUCTURES AND THE PROPERTIES DESIGNATED AS BEING OWNED IN FEE BY SCE&G.

SURVEYORS STATEMENT
 I HEREBY CERTIFY TO THE FEDERAL ENERGY REGULATORY COMMISSION (FERC) THAT THIS PLAN MEETS THE CONDITIONS SET FORTH BY FERC FOR ITS EXPRESSED PURPOSE. THE PURPOSE OF THIS MAP IS TO PROVIDE A GEOREFERENCED VISUAL DEPICTION OF THE LOCATION OF PROJECT FEATURES AND BOUNDARIES BASED ON THE BEST AVAILABLE HISTORICAL DRAWINGS AND DIGITAL REFERENCE SOURCES INCORPORATED INTO THE GEOGRAPHIC INFORMATION SYSTEM (GIS). LOCATIONS HAVE NOT BEEN VERIFIED BY PHYSICAL FIELD SURVEYS AND THIS DRAWING SHOULD NOT BE USED FOR PURPOSES OF DEVELOPING PROPERTY BOUNDARY DESCRIPTIONS.

Path: C:\Archival_Client_Data\SCE&G\Stevens Creek_PBL.mxd

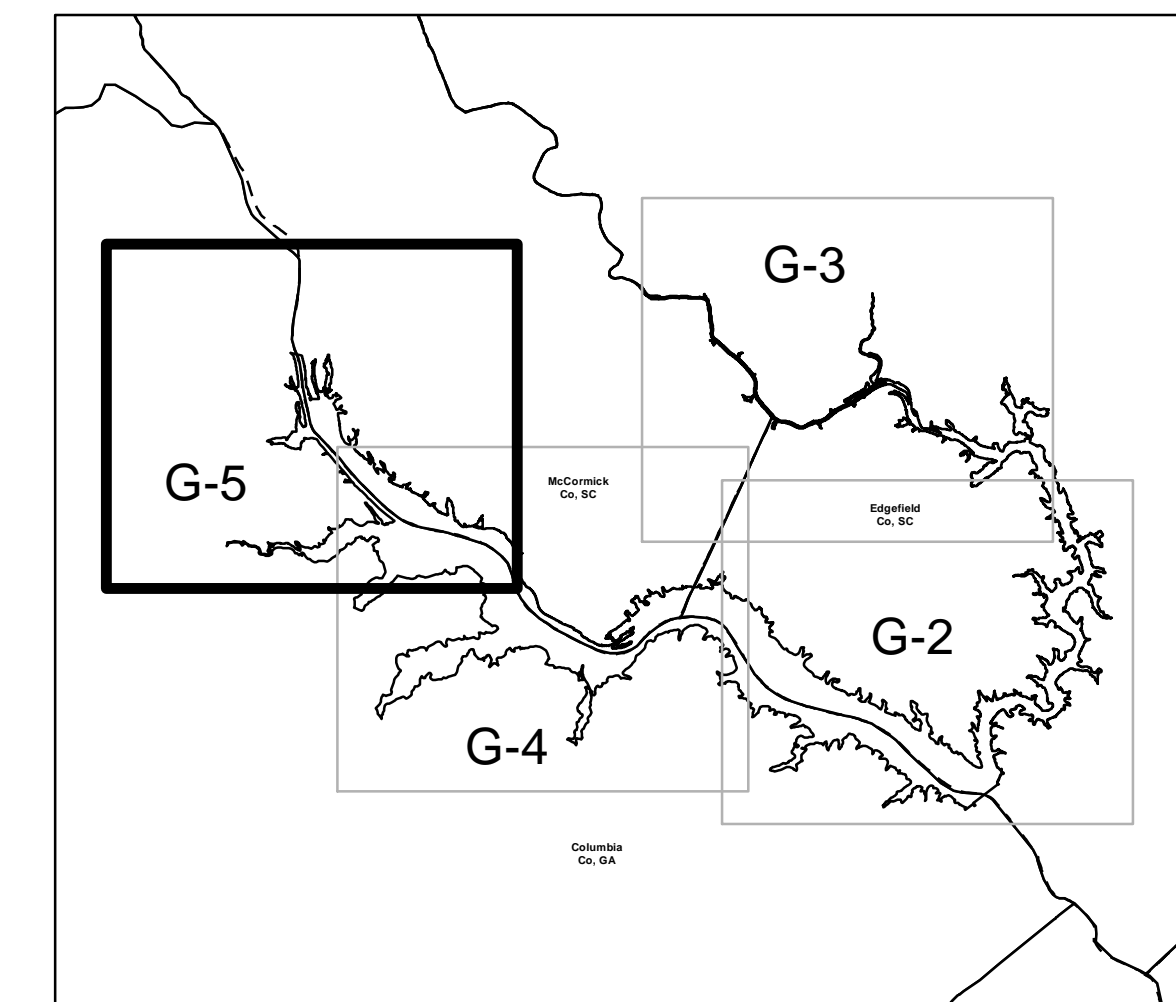
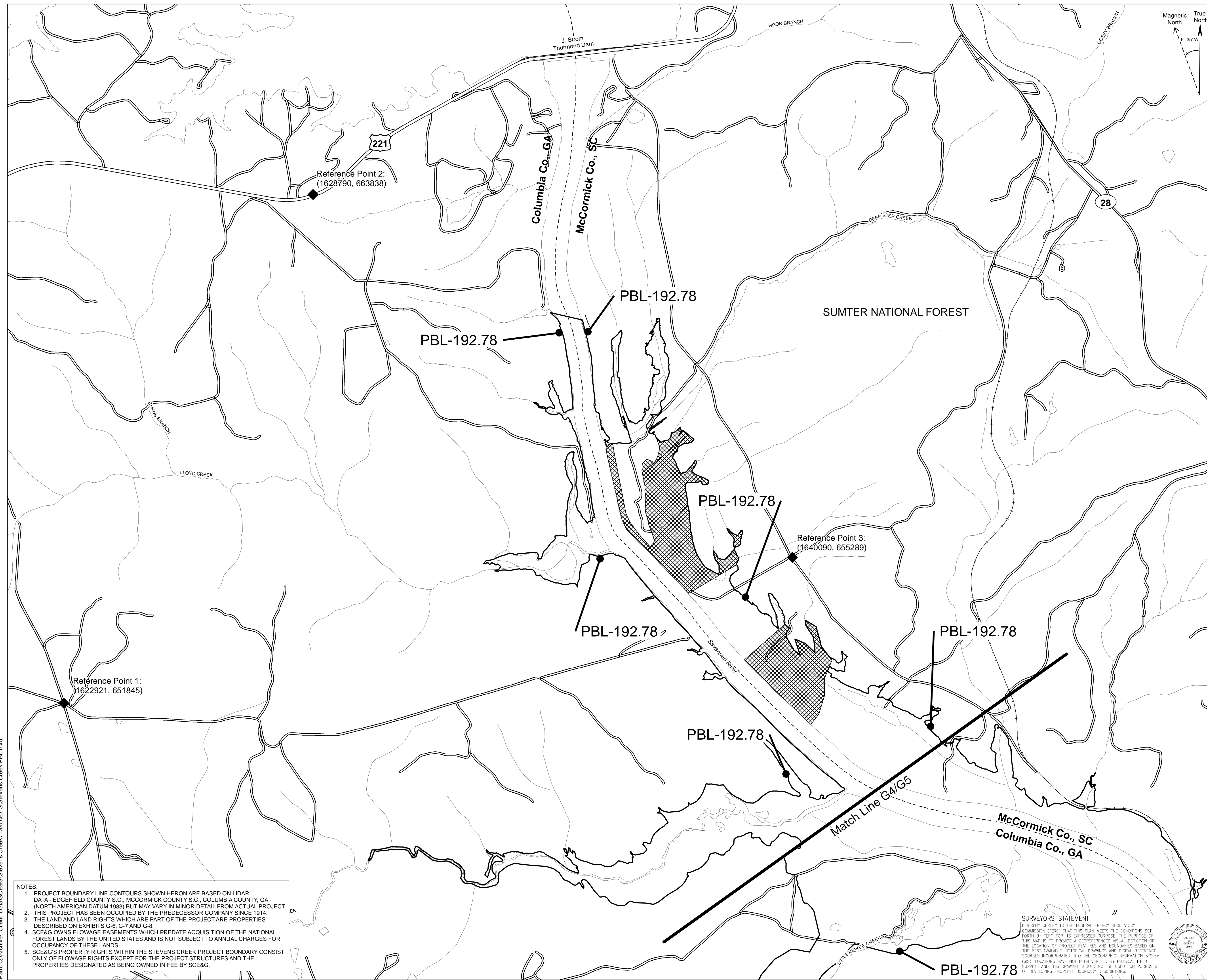

NOTES:

1. PROJECT BOUNDARY LINE CONTOURS SHOWN HEREON ARE BASED ON LIDAR DATA - EDGEFIELD COUNTY S.C., MCCORMICK COUNTY S.C., COLUMBIA COUNTY, GA - (NORTH AMERICAN DATUM 1983) BUT MAY VARY IN MINOR DETAIL FROM ACTUAL PROJECT.
2. THIS PROJECT HAS BEEN OCCUPIED BY THE PREDECESSOR COMPANY SINCE 1914.
3. THE LAND AND LAND RIGHTS WHICH ARE PART OF THE PROJECT ARE PROPERTIES DESCRIBED ON EXHIBITS G-6, G-7 AND G-8.
4. SCE&G OWNS FLOWAGE EASEMENTS WHICH PREDATE ACQUISITION OF THE NATIONAL FOREST LANDS BY THE UNITED STATES AND IS NOT SUBJECT TO ANNUAL CHARGES FOR OCCUPANCY OF THESE LANDS.
5. SCE&G'S PROPERTY RIGHTS WITHIN THE STEVENS CREEK PROJECT BOUNDARY CONSIST ONLY OF FLOWAGE RIGHTS EXCEPT FOR THE PROJECT STRUCTURES AND THE PROPERTIES DESIGNATED AS BEING OWNED IN FEE BY SCE&G.

- Project Boundary Line
- ▨ Property owned in fee by DESC
- ▤ USFS Land within PBL (without pre-existing easement)
- ▥ USFS Land Within PBL (with pre-existing easement)
- ▧ USFS Land Adjacent to PBL

Coordinate System: NAD 1983 NRS2007 StatePlane South Carolina FIPS 3900 Ft Intl
All elevations are in NAVD83.

EXHIBIT G

Exhibit G-5
Detailed Map of Project Area
Dominion Energy South Carolina, Inc.
Stevens Creek Hydroelectric Project
FERC Project No. 2535
1" = 1,000'

SURVEYORS STATEMENT

I HEREBY CERTIFY TO THE FEDERAL ENERGY REGULATORY COMMISSION (FERC) THAT THIS PLAN MEETS THE CONDITIONS SET FORTH BY FERC FOR ITS EXPRESSED PURPOSE. THE PURPOSE OF THIS MAP IS TO PROVIDE A GEOREFERENCED VISUAL DEPICTION OF THE LOCATION OF PROJECT FEATURES AND BOUNDARIES BASED ON THE BEST AVAILABLE HISTORICAL DRAWINGS AND DIGITAL REFERENCE SOURCES INCORPORATED INTO THE GEOGRAPHIC INFORMATION SYSTEM (GIS). LOCATIONS HAVE NOT BEEN VERIFIED BY PHYSICAL FIELD SURVEYS AND THIS DRAWING SHOULD NOT BE USED FOR PURPOSES OF DEVELOPING PROPERTY BOUNDARY DESCRIPTIONS.

Path: C:\Archival_Client_Data\SCE&G\Stevens Creek\IMXD\EX_G\Stevens Creek PBL.mxd